

FLUE SYSTEM AD

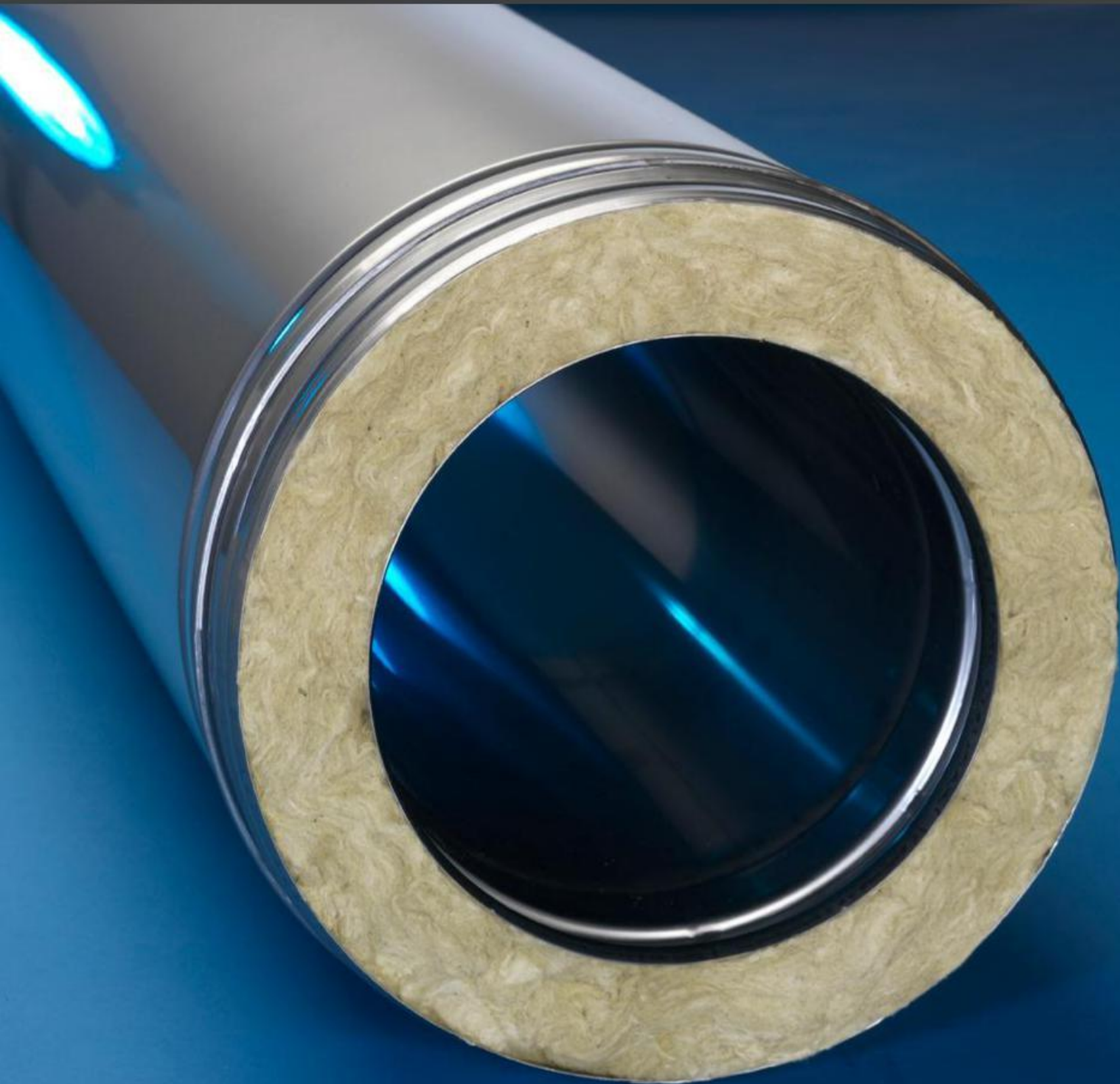

Technical Data SYSTEM AD

Application: Chimney/Flue System/Connecting Flue

Operating Mode: Dry
Pressure : Negative/positive pressure
Max. working pressure: 5000Pa
Operating temperature: 600°C
Max. temperature allowed: 1000°C

Inner wall	material	AISI 316L/EN 1.4404
	thickness	Ø 130 – Ø250: 0,4, Ø300 – Ø400: 0,5, Ø450: 0,6
Outer wall	material	AISI 304L/EN 1.4301
	thickness	Ø 130 – Ø250: 0,4, Ø300 – Ø400: 0,5, Ø450: 0,6
Insulation	type	Mineral Wool
	thickness	Ø 130 – Ø450: 37,5
Sealant:		Elastomer
Fuel Type:		Gas/diesel/oil

Applications SYSTEM AD

- Gas/Diesel engines
- (Emergency) power gensets
- Uninterrupted Power Supply (UPS)
- Industrial processes

Advantages SYSTEM AD

- Inner and outer wall from high quality stainless steel
- No thermal bridges better heat protection
- Stress free thermal expansion
- Fast and simple installation
- High quality insulation uninterrupted insulation from base to stop stub
- Immediately ready for use

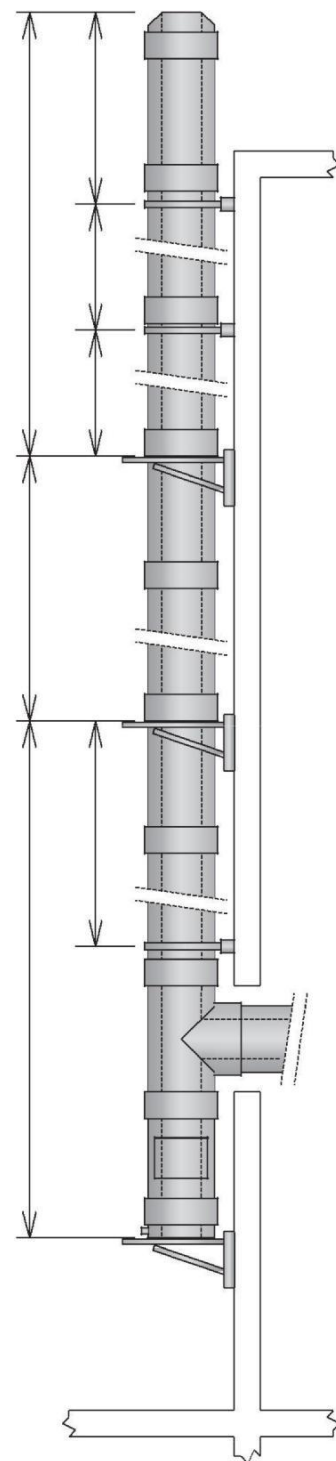

	DIAMETER			CROSS SECTIONAL AREA				WEIGHT KG/M	
Inner Diameter mm	130	150	180	200	250	300	350	400	450
Outer Diameter mm	205	225	255	275	325	375	425	475	525
Cross Section cm ²	133	177	254	314	491	707	962	1257	1590
Weight kg/m	7.5	8	10	11	12.5	15.5	18.5	22	23.5

ADA Adaptor

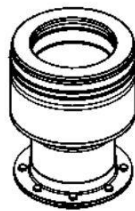
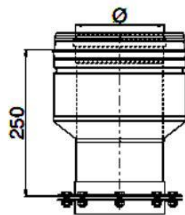

Ø 130 150 180 200 250 300 350 400 450 500 600

ADA 00 Adaptor

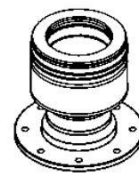
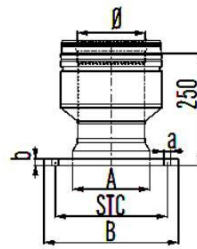

Ø 130 150 180 200 250 300 350 400 450 500 600
A to be specified on order
B to be specified on order
STC to be specified on order
a to be specified on order
b 14 14 16 16 16 18 18 20 20 20 22
or specify on order

ADAS Adaptor without flange

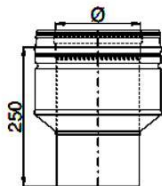

Ø 130 150 180 200 250 300 350 400 450 500 600

ADB 15 Elbow 15°

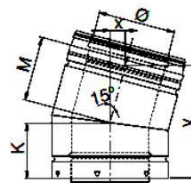

Ø 130 150 180 200 250 300 350 400 450 500 600
K 110 110 110 110 110 110 110 110 110 110 110
M 110 110 110 110 110 110 110 110 110 110 110
x 30 30 30 30 30 30 30 30 30 30 30
y 215 215 215 215 215 215 215 215 215 215 215

ADB 30 Elbow 30°

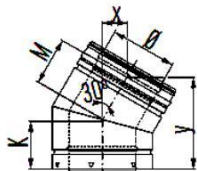

Ø 130 150 180 200 250 300 350 400 450 500 600
K 110 110 110 110 110 110 155 165 135 145 155
M 110 110 110 110 110 110 155 165 135 145 155
x 55 55 55 55 55 55 75 80 70 75 80
y 205 205 205 205 205 205 290 310 250 270 290

ADB 45 Elbow 45°

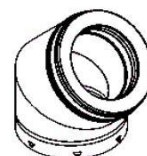
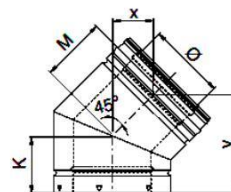

Ø 130 150 180 200 250 300 350 400 450 500 600
K 110 110 120 120 135 145 155 165 175 185 205
M 110 110 120 120 135 145 155 165 175 185 205
x 80 80 85 85 95 105 110 115 125 130 145
y 190 190 205 205 230 250 265 280 300 315 350

ADB90
Elbow 90°

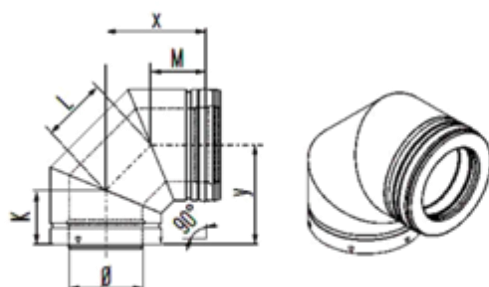

Ø	130	150	180	200	250	300	350	400	450	500	600
K	115	115	125	130	135	145	155	165	175	185	205
L	105	105	135	145	165	185	205	230	255	275	320
M	115	115	125	130	135	145	155	165	175	185	205
x	190	190	220	235	255	275	300	330	355	380	435
y	190	190	220	235	255	275	300	330	355	380	435

ADB190
Elbow 90° with inspection cover, negative pressure

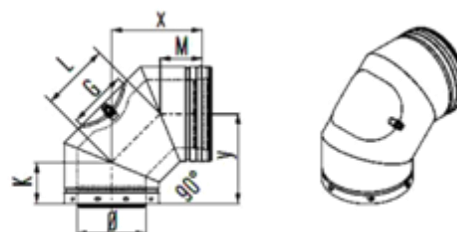

Ø	130	150	180	200	250	300	350	400	450	500	600
G	130	140	140	140	180	180	180	240	240	240	240
K	105	105	115	120	125	135	155	165	175	185	205
L	160	155	145	155	175	195	215	235	300	320	365
M	115	115	125	130	135	145	185	195	205	215	235
x	230	225	230	240	260	285	340	405	420	445	495
y	220	215	220	230	250	275	310	335	390	415	465

ADT 45
Tee-piece 45°

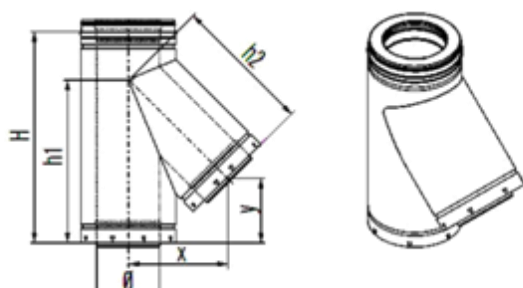

Ø	130	150	180	200	250	300	350	400	450	500	600
H	500	500	500	600	700	700	770	970	970	970	1120
h1	375	385	385	475	565	555	645	835	830	820	950
h2	305	325	370	390	455	510	565	630	695	750	875
x	215	235	260	275	320	360	405	445	490	535	620
y	160	155	125	200	245	195	245	390	340	290	330

ADT 90
Tee-piece 90°

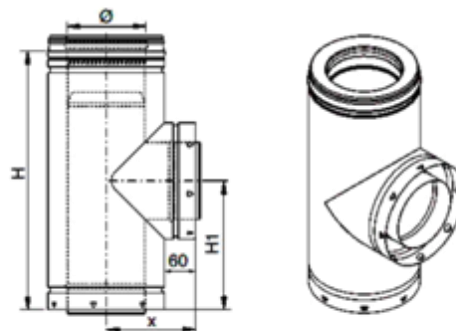

Ø	130	150	180	200	250	300	350	400	450	500	600
H	490	490	490	490	490	600	600	700	700	800	1000
H1	240	240	240	240	240	300	300	350	350	400	500
X	165	175	190	200	225	250	275	300	325	350	400

AD 100/50/30/25/20
Length

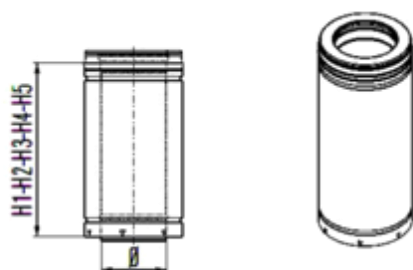

Ø	130	150	180	200	250	300	350	400	450	500	600
H1	1000	1000	1000	1000	1000	1000	1000	1000	1000	1000	1000
H2	500	500	500	500	500	500	500	500	500	500	500
H3	300	300	300	300	300	300	300	300	—	—	—
H4	—	—	—	—	—	—	—	—	250	250	250
H5	200	200	200	200	200	—	—	—	—	—	—

ADPP
Adjustable length

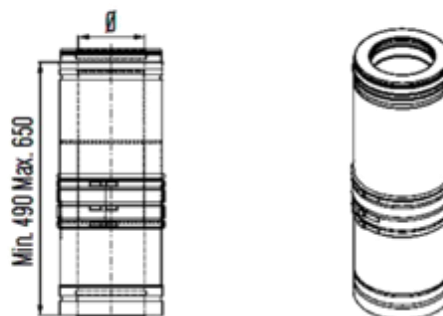

Ø	130	150	180	200	250	300	350	400	450	500	600
---	-----	-----	-----	-----	-----	-----	-----	-----	-----	-----	-----

ADEM

Probe length (incl. cap)



Ø	130	150	180	200	250	300	350	400	450	500	600
---	-----	-----	-----	-----	-----	-----	-----	-----	-----	-----	-----

ADEMC

Length with drain, vertical

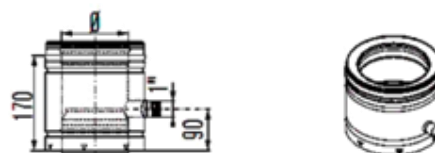

Ø	130	150	180	200	250	300	350	400	450	500	600
---	-----	-----	-----	-----	-----	-----	-----	-----	-----	-----	-----

ADI

Inspection element, negative pressure

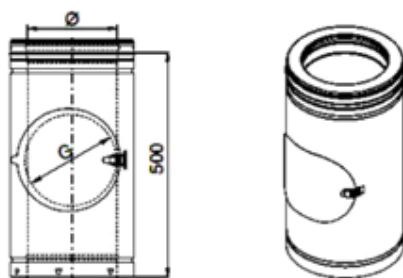

Ø	130	150	180	200	250	300	350	400	450	500	600
G	130	140	140	140	180	180	180	240	240	240	240

ADRBK

Condensate collector with drain



Ø	130	150	180	200	250	300	350	400	450	500	600
H	85	85	85	85	85	85	120	120	120	120	120

ADSIA1

Absorption silencer 25 dB

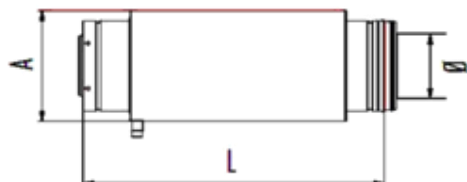
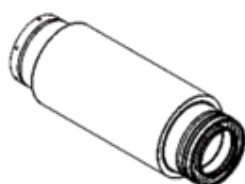

Ø	130	150	180	200	250	300	350	400	450	500	600
L	750	750	1000	1250	1250	1750	1750	1750	2000	2000	2000
A	255	275	305	325	375	425	475	525	575	625	725

ADTR

Cleaning/ inspection element

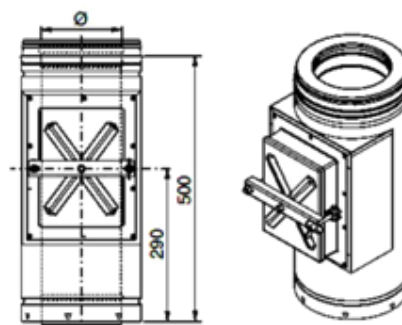

Ø	130	150	180	200	250	300	350	400	450	500	600
---	-----	-----	-----	-----	-----	-----	-----	-----	-----	-----	-----

ADSIA2

Absorption silencer 35 dB

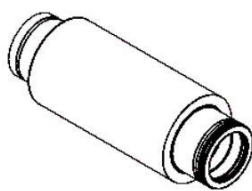

Ø	130	150	180	200	250	300	350	400	450	500	600
L	1000	1000	1250	1500	1500	2500	2500	2500	3000	3000	3000
A	255	275	325	325	375	425	475	525	575	625	725

ADSIR1

Resonance silencer 20 dB

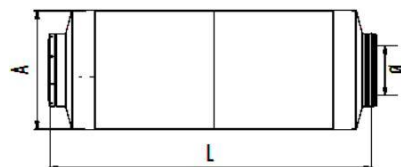
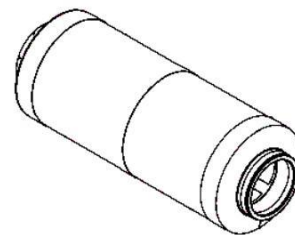

Ø	130	150	180	200	250	300	350	400	450	500	600
L	2200	2200	2200	2200	2200	2200	2200	2200	2200	2200	2200
A	450	500	600	650	700	850	950	1000	1100	1150	1350

ADSIR2

Resonance silencer 30 dB

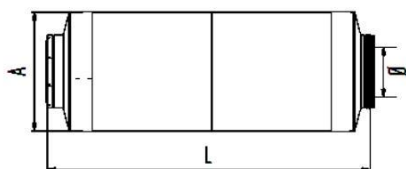
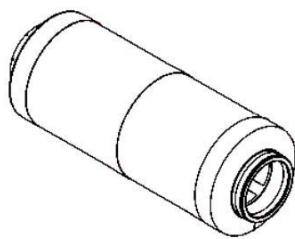

Ø	130	150	180	200	250	300	350	400	450	500	600
L	2200	2200	2200	2200	2400	2600	2800	3000	3200	3400	3600
A	650	750	800	850	1000	1000	1100	1200	1300	1350	1550

ADSIC1

Combination silencer 25 dB

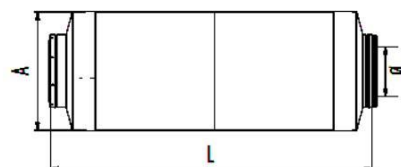
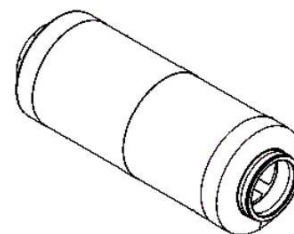

Ø	130	150	180	200	250	300	350	400	450	500	600
L	1870	1870	2120	2370	2620	3120	3370	3870	4370	4620	4870
A	500	525	575	625	675	875	975	1050	1100	1225	1325

ADSK

Reinforced locking band

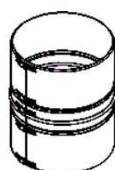
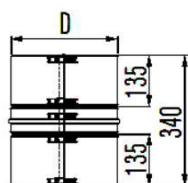

Ø	130	150	180	200	250	300	350	400	450	500	600
D	205	225	255	275	325	375	425	475	525	575	675

ADAPU

Rotating base plate with condensate drain

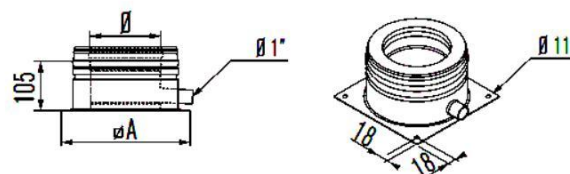

Ø	130	150	180	200	250	300	350	400	450	500	600
A	240	260	290	310	360	410	460	510	560	610	635

ADAP0

Wall support element

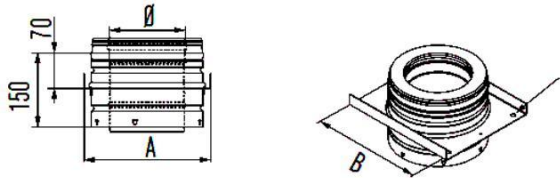

Ø	130	150	180	200	250	300	350	400	450	500	600
A	240	260	290	310	360	410	460	510	560	610	710
B	290	310	340	360	410	460	510	560	610	660	760

ADMB

Wall band adjustable

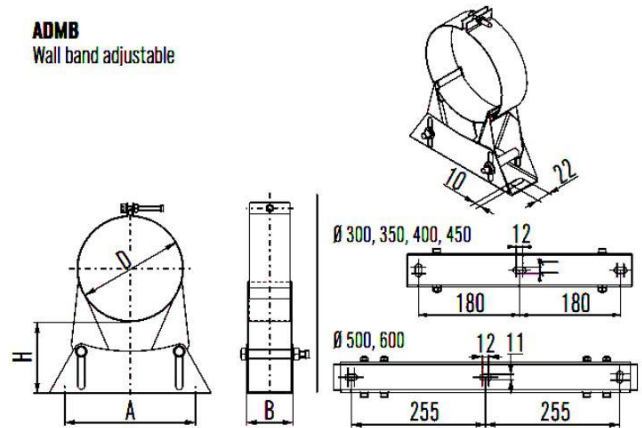

Ø	130	150	180	200	250	300	350	400	450	500	600
D	205	225	255	275	325	375	425	475	525	575	675
A	160	160	160	160	160	360	360	360	360	510	510
B	55	55	55	55	55	60	60	60	60	60	60
H	50-90	50-90	50-90	50-90	50-90	50-90	50-90	50-90	50-90	50-90	50-90

ADMBV2, ADMBV3, ADMBV4

Wall band adjustable

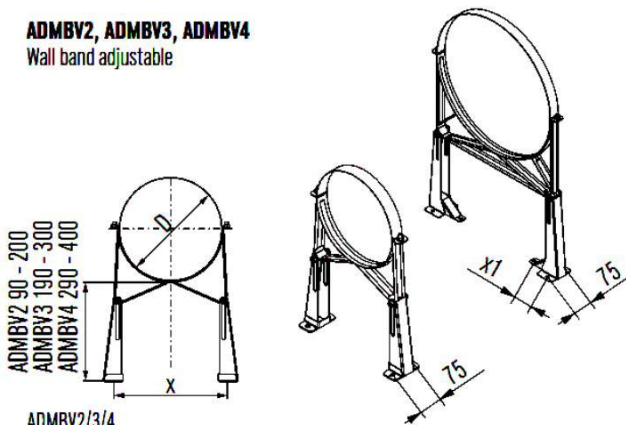

ADMBV2/3/4

Ø	130	150	180	200	250	300	350	400	450	500	600
D	205	225	255	275	325	375	425	475	525	575	675
x	235	255	285	305	355	405	455	505	535	585	685
x1	ADMBV2	-	-	-	-	-	-	-	-	70	70
	ADMBV3	-	-	-	-	-	-	-	-	110	110

ADPH

Ceiling hanger



Ø	130	150	180	200	250	300	350	400	450	500	600
D	205	225	255	275	325	375	425	475	525	575	675

ADVQ

Ceiling support

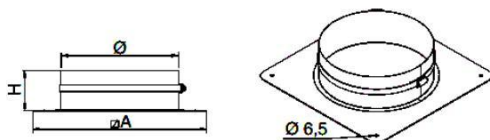

Ø	130	150	180	200	250	300	350	400
A	305	325	355	375	425	475	525	575
D	205	225	255	275	325	375	425	475
H	70	70	70	70	70	95	95	95

ADDQ

Roof support

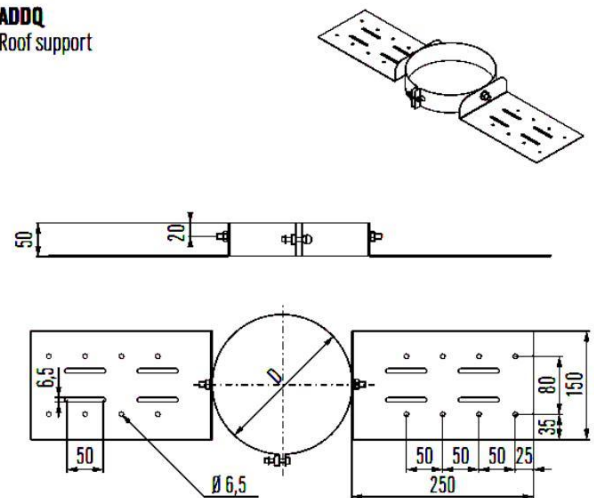

Ø	130	150	180	200	250	300	350	400	450	550	600
D	205	225	255	275	325	375	425	475	525	575	675

ADMOG

Band for fixation, smooth

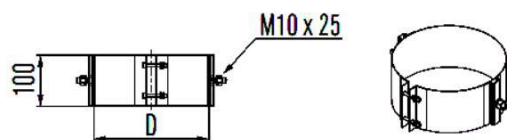

Ø	130	150	180	200	250	300	350	400	450	500	600
D	205	225	255	275	325	375	425	475	525	575	675

ADS

Storm collar

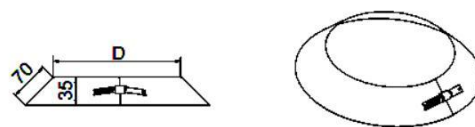

Ø	130	150	180	200	250	300	350	400	450	500	600
D	205	225	255	275	325	375	425	475	525	575	675

ADMA

Top stub



Ø	130	150	180	200	250	300	350	400	450	500	600
---	-----	-----	-----	-----	-----	-----	-----	-----	-----	-----	-----

ADHT

Horizontal terminal (incl. mesh)

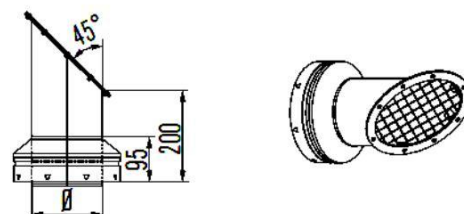

Ø	130	150	180	200	250	300	350	400	450	500	600
---	-----	-----	-----	-----	-----	-----	-----	-----	-----	-----	-----

ADBT

Guy-wire band



Ø	130	150	180	200	250	300	350	400	450	500	600
D	205	225	255	275	325	375	425	475	525	575	675

ADCP

Cover plates (pair)

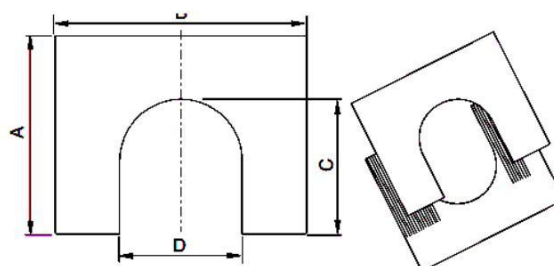

Ø	130	150	180	200	250	300	350	400	450	500	600
A	370	370	390	420	465	465	465	540	575	625	725
B	465	465	465	530	550	600	625	625	725	775	875
C	275	250	270	300	345	345	350	420	475	525	625
D	205	225	255	275	325	375	425	475	525	575	675

Whilst every effort has been made to provide reliable information and dimension accuracy, Sigram Flue Systems Ltd, do not hold themselves responsible for possible errors of an editorial nature, however caused.

Sigram are committed to the concept of continuous quality and improvement and therefore reserves the right to alter product specification without notice.



**UNIT E2
MEADOWBANK BUSINESS PARK
TWEEDALE WAY
CHADDERTON
OLDHAM, OL9 8EH**

**TEL: 0161 682 1999
FAX: 0161 681 9855
EMAIL: sales@sigram.co.uk
WEB: www.sigram.co.uk**