

FLUE SYSTEM ME

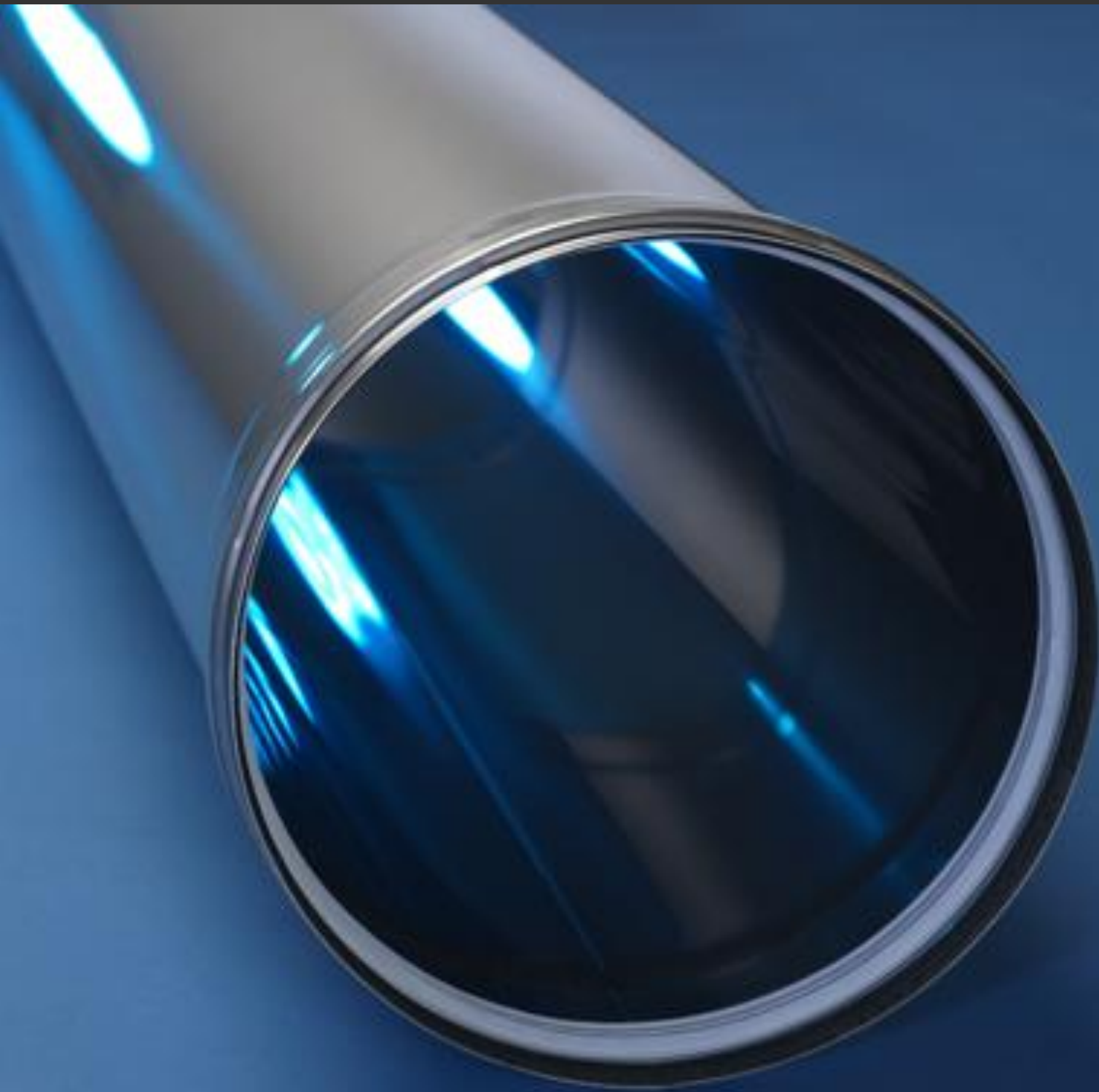

Technical Data SYSTEM ME

Application:	Chimney/Flue System/Connecting Flue
Operating Mode:	Dry/Wet
Pressure:	Negative/positive pressure
Max. working pressure:	5000Pa
Operating temperature:	600°C negative pressure 200°C positive pressure
Max. temperature allowed:	1000°C negative pressure (max 30 min.) 200°C positive pressure
Material:	AISI 316L/EN 1.4404
Thickness:	ø80 - ø600 (0.6)
Sealant:	Elastomer
Fuel Type:	Gas

INSTALLATION NOTES SPECIFICALLY FOR CONDENSING APPLICATIONS.

On all condensing applications, system must be fitted with a minimum 3 degree slope back towards the appliance/s. (appliance and/or system drain point required at lowest point/s.)

Note: A system slope of 3 degrees equates to 5.2CM per linear metre.

Systems must be adequately supported, with horizontal run supports not exceeding two metre centres.

Applications SYSTEM ME

- Shaft liner in renovation projects
- Air inlet & ventilation systems
- Flue system for condensing heaters and boilers
- Chimney renovation

Advantages SYSTEM ME

- Stress free thermal expansion
- Can be connected to System MF
- High quality stainless steel system
- High temperature silicone sealing ring
- Universal application
- Fully welded system with sealing ring
- Light weight system

Installation Method

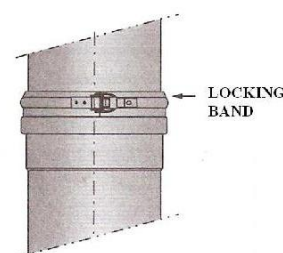
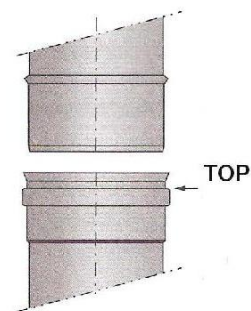

Check all parts for possible damage.

During installation you may have to use our special installing grease.

The installation of the chimney starts at the appliance and then progresses upwards to the terminal.

The top of each element can be recognised by the profile edge (fig.1).
At the bottom of each section (ME 100) an arrow is printed which indicates the direction of flow.

Connect two elements by pushing them vertically into each other. For visual reasons it is advisable to place the welding seams at the rear if possible.

The sealing ring in the inner wall must remain in its position and must not be damaged during connection of the elements.

When the elements are connected then fix the locking band (fig. 2)

Then install the next element as instructed

	DIAMETER				CROSS SECTIONAL AREA				WEIGHT (KG/M)		
	80	100	130	150	180	200	250	300	350	400	
Diameter mm	80	100	130	150	180	200	250	300	350	400	
	50	79	133	177	254	314	491	707	962	1256	
Cross Section (cm²)	50	79	133	177	254	314	491	707	962	1256	
	1.5	1.5	2	2.5	3	3	4	4.5	5.5	6	
Weight (kg/m)	1.5	1.5	2	2.5	3	3	4	4.5	5.5	6	

MEKAS

Boiler adaptor with outer sealing ring

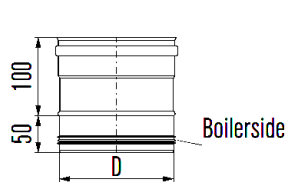

Ø	80	100	113	130	150	180	200	250	300	350	400	450	500	600
D	79	99	110	129	149	179	199	249	299	349	399	449	499	599

MEVG

Increaser

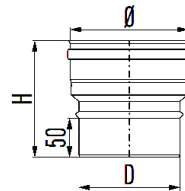

Ø	80	80	100	113	130	130	130	150	150	180	180	200	200	250	300	350	400	450	500	600
D	60	70	80	100	80	100	113	100	130	130	150	150	180	200	250	300	350	400	450	500
H	165	165	165	165	155	145	195	195	195	140	195	155	195	230	230	230	230	230	230	230

MEVG00

Increaser

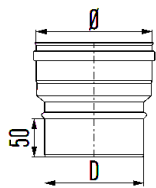

Ø	100	113	130	150	180	200	250	300	350	400	450	500	600
D	to be specified on order,												

MEVGE

Increaser, eccentric

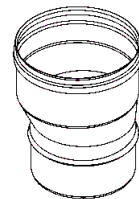
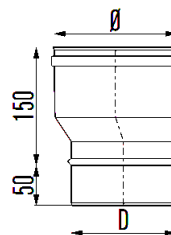

Ø	100	113	130	150	180	200	250	300	350	400
D	80	100	113	130	150	180	200	250	300	350

MEVGE00

Increaser excentric

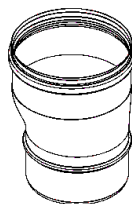
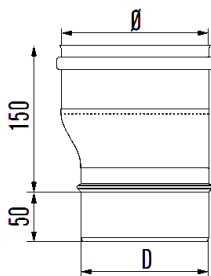

Ø	100	113	130	150	180	200	250	300	350	400
D	to be specified on order									

MEVK

Reducer

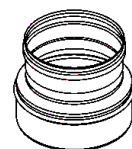
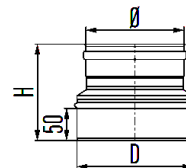

Ø	80	100	113	130	100	150	180	200	250	300	350	400	450	500
D	100	113	130	150	130	180	200	250	300	350	400	450	500	600
H	165	165	195	195	165	195	195	230	230	230	230	230	230	230

MEDM Adaptor double female

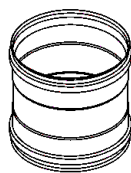
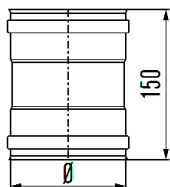

Ø 80 100 113 130 150 180 200 250 300 350 400

MEVK00 Reducer

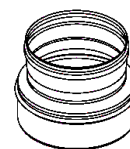
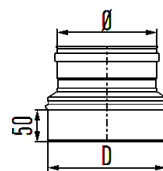

Ø 80 100 113 130 150 180 200 250 300 350 400 450 500 600
D to be specified on order

MEB 15 Elbow 15°

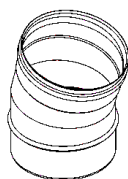
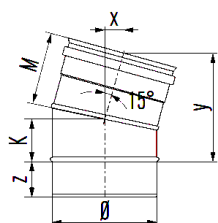

Ø	80	100	113	130	150	180	200	250	300	350	400	450	500	600
K	35	40	40	45	50	55	60	70	70	70	85	65	65	65
M	80	85	85	90	95	100	105	115	115	115	130	140	140	140
x	20	20	20	20	25	25	25	30	30	30	35	35	35	35
y	105	115	120	125	135	145	155	175	175	175	205	200	200	200
z	50	50	50	50	50	50	50	50	50	50	55	55	55	55

MEB 30 Elbow 30°

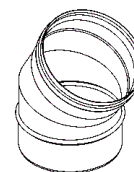
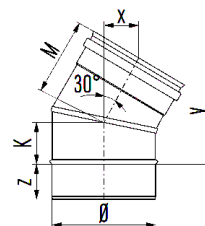

Ø	80	100	113	130	150	180	200	250	300	350	400	450	500	600
K	35	40	40	45	50	55	60	70	70	70	85	90	100	110
M	80	85	85	90	95	100	105	115	115	115	130	135	145	155
x	40	40	40	45	45	50	50	55	55	55	65	65	70	80
y	100	110	110	120	130	135	145	165	165	165	195	205	225	245
z	50	50	50	50	50	50	50	50	50	50	55	55	55	55

MEB 45 Elbow 45°

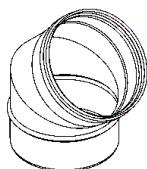
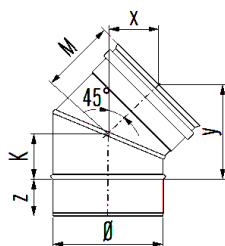

Ø	80	100	113	130	150	180	200	250	300	350	400	450	500	600
K	35	40	40	45	50	55	60	70	95	95	105	130	140	160
M	80	85	85	90	95	100	105	115	140	140	150	205	215	235
x	55	60	60	60	65	70	70	80	95	95	105	145	150	165
y	90	95	95	105	115	125	130	150	190	190	205	275	290	326
z	50	50	50	50	50	50	50	50	50	50	55	55	55	55

MEB 87 Elbow 87°

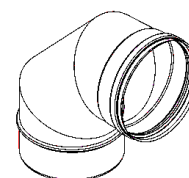
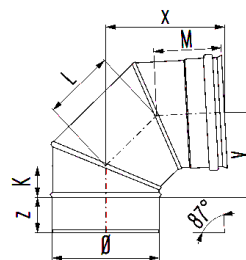

Ø	80	100	113	130	150	180	200	250	300	350	400	450	500	600
K	35	40	40	45	50	55	60	70	95	95	105	130	140	160
L	100	105	115	115	125	145	165	185	210	210	230	300	320	385
M	80	85	85	90	95	100	105	115	140	140	150	205	215	235
x	150	160	165	170	185	200	220	245	290	290	310	420	445	515
y	105	115	120	125	140	160	175	200	245	245	270	345	370	435
z	50	50	50	50	50	50	50	50	50	50	55	55	55	55

MEB 90 Elbow 90°

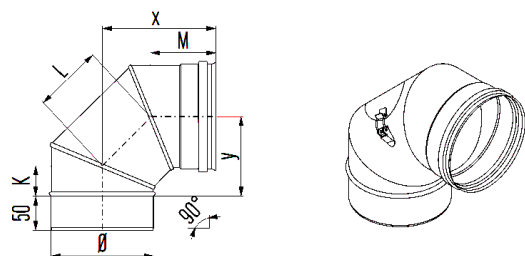

Ø	80	100	113	130	150	180	200	250	300	350	400	450	500	600
K	35	40	40	45	50	55	60	70	95	95	105	130	140	160
L	100	105	115	115	125	145	165	185	210	210	230	300	320	385
M	80	85	85	90	95	100	105	115	140	140	150	205	215	235
x	150	160	165	170	185	200	220	245	290	290	310	420	440	495
y	105	115	120	125	140	160	175	200	245	245	270	340	365	420
z	50	50	50	50	50	50	50	50	50	50	50	55	55	55

MEBV45 Elbow 45°, adjustable (for negative pressure only)

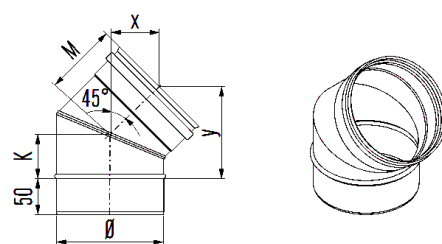

Ø	113	130	150	180	200	250
K	50	55	55	65	70	80
M	95	100	105	110	110	125
x	65	70	75	80	80	90
y	115	125	130	140	145	170

MEBI45 Elbow 45° with inspection cover

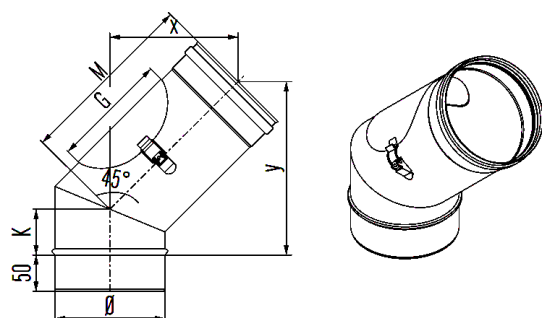

Ø	130	150	180	200	250	300	350
G	130	140	140	140	180	180	180
K	55	60	70	70	70	70	120
M	250	250	250	250	250	250	250
x	175	175	175	175	175	175	175
y	230	235	245	245	245	250	300

MEBI 87 Elbow 87° with inspection cover

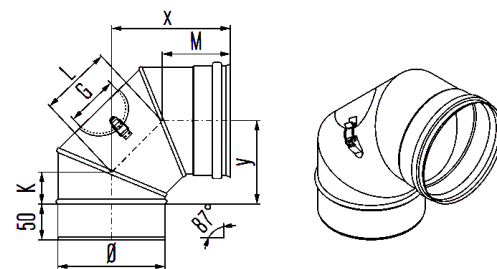

Ø	80	100	113	130	150	180	200	250	300	350	400	450	500	600
G	65	100	100	130	140	140	140	180	180	180	240	240	240	240
K	35	40	40	45	50	55	60	70	95	95	105	125	135	155
L	100	105	115	115	125	145	165	185	210	210	230	300	320	385
M	80	85	85	90	95	100	105	115	140	140	150	205	215	235
x	150	160	165	170	185	200	220	245	290	290	310	390	420	520
y	105	115	120	125	140	160	175	200	245	245	270	340	370	470

MEBI 90 Elbow 90° with inspection cover

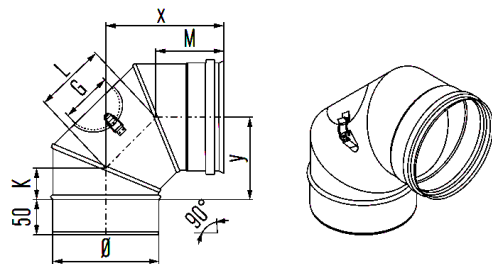

Ø	80	100	113	130	150	180	200	250	300	350	400	450	500	600
G	65	100	100	130	140	140	140	180	180	180	240	240	240	240
K	35	40	40	45	50	55	60	70	95	95	105	125	135	155
L	100	105	115	115	125	145	165	185	210	210	230	300	320	385
M	80	85	85	90	95	100	105	115	140	140	150	205	215	235
x	150	160	165	170	185	200	220	245	290	290	310	390	420	520
y	105	115	120	125	140	160	175	200	245	245	270	340	370	470

MEBIC 90 Elbow 90° with inspection cover, negative pressure

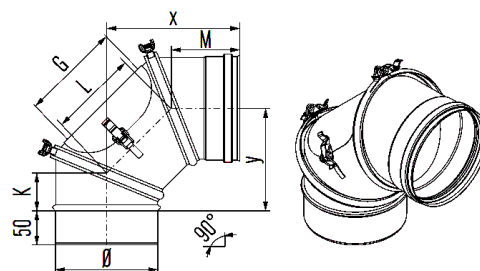

Ø	130	150
G	130	140
K	45	50
L	115	125
M	90	95
x	170	180
y	125	135

MET 45

Tee-piece 45° with condensate deflector

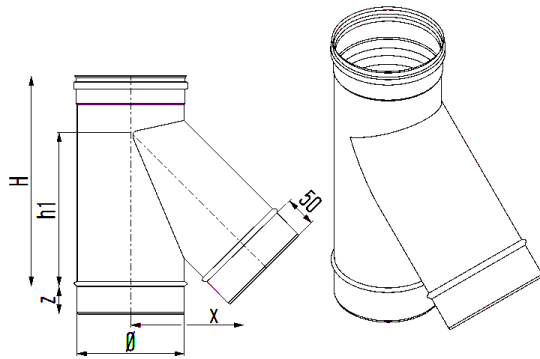

Ø	80	100	113	130	150	180	200	250	300	350	400	450	500	600
H	340	380	420	450	450	470	470	600	690	690	890	985	985	1135
h1	190	230	280	310	310	310	310	410	450	500	550	780	780	900
x	115	135	145	155	165	175	185	285	340	360	425	452	463	552
z	50	50	50	50	50	50	50	50	50	50	50	55	55	55

MET 87

Tee-piece 87° with condensate deflector

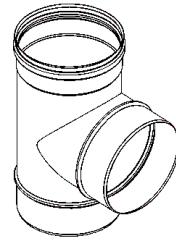
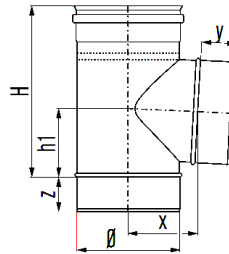

Ø	80	100	113	130	150	180	200	250	300	350	400	450	500	600
H	200	200	200	250	250	300	300	350	450	500	550	685	785	985
h1	75	75	75	100	100	125	125	150	200	225	250	315	365	465
x	65	80	85	95	105	120	130	155	185	210	235	290	315	365
y	50	50	50	50	50	50	50	50	50	50	50	55	55	55
z	50	50	50	50	50	50	50	50	50	50	50	55	55	55

MET 90

Tee-piece 90° with condensate deflector

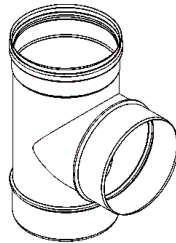
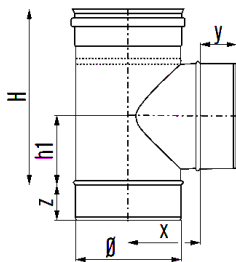

Ø	80	100	113	130	150	180	200	250	300	350	400	450	500	600
H	200	200	200	250	250	300	300	350	450	500	550	685	785	985
h1	75	75	75	100	100	125	125	150	200	225	250	315	365	465
x	60	70	75	85	95	110	120	145	170	195	220	290	315	365
y	50	50	50	50	50	50	50	50	50	50	50	55	55	55
z	50	50	50	50	50	50	50	50	50	50	50	55	55	55

META87

Tee-piece 87° with sepeare branch (for negative pressure only)

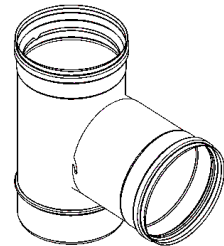
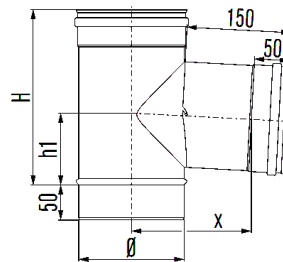

Ø	113	130	150	180
H	200	250	250	300
h1	75	100	100	125
x	155	165	175	190

METV08

Tee-piece 87°, reducing

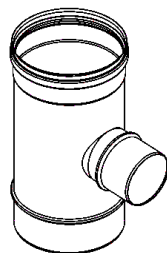
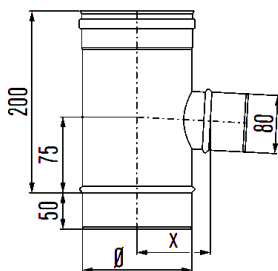

Ø	100	130	150	180	200	250
x	75	90	100	115	125	150

MET 45XX

Tee-piece 45°, reducing

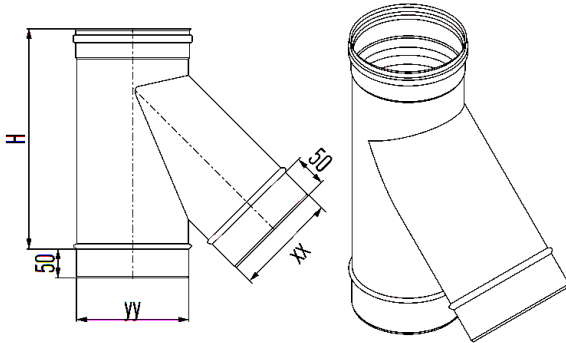

Table for H

	100	130	150	180	200	yy = Ø body (mm)									
80	380	380	380	380	380	380	380	380	380	380	380	380	380	380	380
100		380	380	380	380	380	380	380	380	380	380	380	380	380	380
130			450	450	450	450	450	450	450	450	450	450	450	450	450
150				450	450	450	450	450	450	450	450	450	450	450	450
180					470	470	470	470	470	470	470	470	470	470	470
200						470	470	470	470	470	470	470	470	470	470
250							470	470	470	470	470	470	470	470	470
300								470	470	470	470	470	470	470	470
350									690	690	690	690	690	690	690
400										690	690	690	690	690	690
450											690	690	690	690	690
500												950	950	950	950

MET 87XX

Tee-piece 87°, reducing

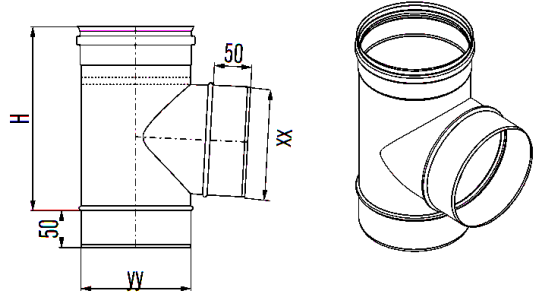

Table for H

	100	130	150	180	200	yy = Ø body (mm)									
80						200	200	200	200	200	200	200	200	200	200
100							200	200	200	200	200	200	200	200	200
130								250	250	250	250	250	250	250	250
150									250	250	250	250	250	250	250
180										300	300	300	300	300	300
200											300	300	300	300	300
250												300	300	300	300
300													350	350	350
350														450	450
400															500
450															550
500															630

MET 90XX

Tee-piece 90° with reducing branch

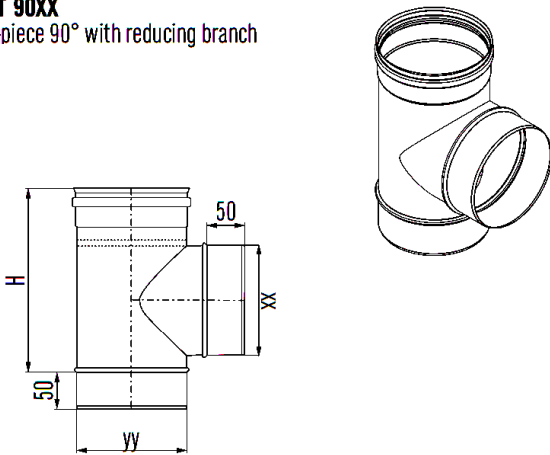
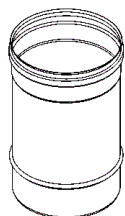
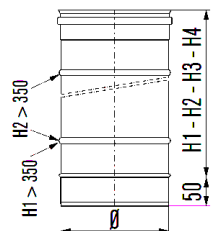

Table for H

	100	130	150	180	200	(yy)									
80	200	200	200	200	200	200	200	200	200	200	200	200	200	200	200
100		200	200	200	250	200	200	200	200	200	200	200	200	200	200
130			250	250	250	250	250	250	250	250	250	250	250	250	250
150				250	300	250	250	250	250	250	250	250	250	250	250
(xx) 180						300	300	300	300	300	300	300	300	300	300
200							300	300	300	300	300	300	300	300	300
250								350	350	350	350	350	350	350	350
300									450	450	450	450	450	450	450
350										500	500	500	500	500	500
400											550	550	550	550	550
450												630	630	630	630
500													680	680	680

ME 100/50/25/15

Length



Ø	80	100	113	130	150	180	200	250	300	350	400	450	500	600
H1	945	945	945	945	945	945	945	945	945	940	940	935	935	935
H2	440	440	440	440	440	440	440	440	440	440	440	435	435	435
H3	205	205	205	205	205	205	205	205	200	200	200	200	200	200
H4	100	100	100	100	100	100	100	100	100	100	100	95	95	95

MEPP

Adjustable length

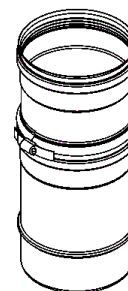
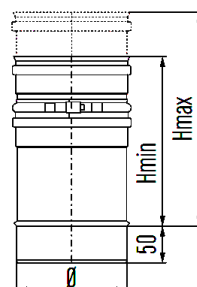

Ø	80	100	113	130	150	180	200	250	300	350	400	450	500	600
Hmin	200	200	200	200	200	200	200	200	200	200	200	200	200	200
Hmax	300	300	300	300	300	300	300	300	300	300	300	300	300	300

MEAE

Mounting aid

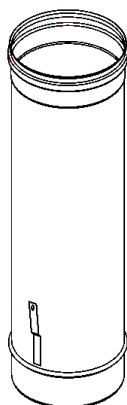
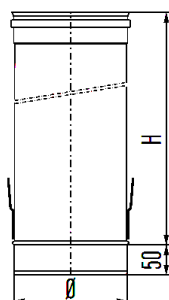

Ø	80	100	113	130	150	180	200	250	300	350	400	500	600
H	950	950	950	950	950	950	950	950	950	950	950	950	950

MEAP

Cover plate (for negative pressure only)

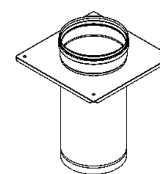
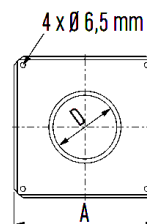
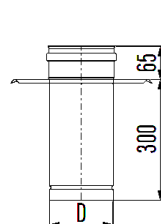

Ø	150	180	200	250	300	350	400	450	500	600
A	335	500	500	500	665	665	665	715	765	865
D	145	175	195	245	295	345	395	445	495	495

MEDD

Adjustable length with double-walled expansion piece (for negative pressure only)

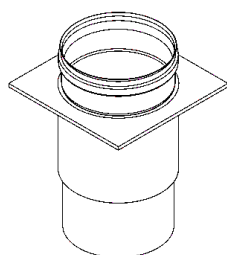
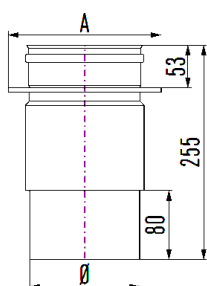

Ø	113	130	150	180	200	250	300	350
A	165	180	200	230	250	300	350	400

MERBK

Condensate collector with drain

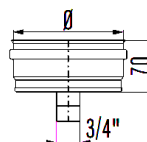

Ø	80	100	130	150	180	200	250	300	350	400	450	500	600
---	----	-----	-----	-----	-----	-----	-----	-----	-----	-----	-----	-----	-----

MEKA

Condensate collector with side drain

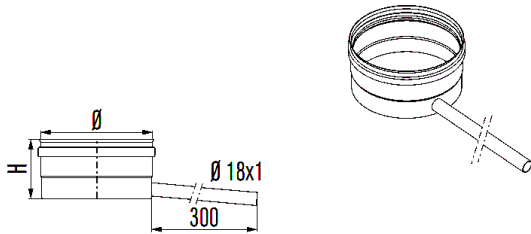

Ø	80	100	113	130	150	180	200	250	300	350	400	450	500	600
H	70	70	70	70	70	70	70	70	95	95	95	100	100	100

MERE

Inspection element (for negative pressure only)

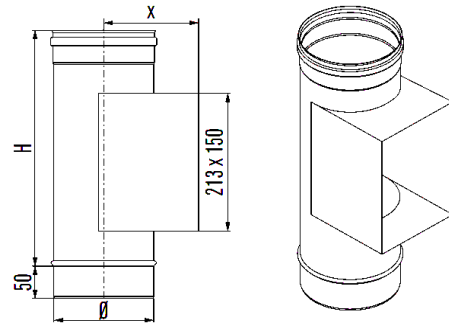

Ø	130	150	180	200	250	300	350	400
H	300	300	300	300	300	320	320	320
x	215	225	240	250	275	300	325	350

MEI

Inspection element

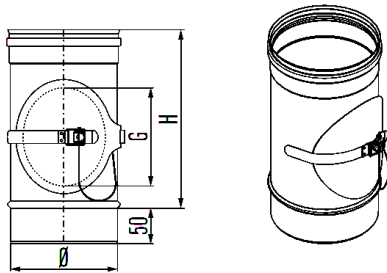

Ø	80	100	113	130	150	180	200	250	300	350	400	450	500	600
H	200	200	200	250	250	250	250	300	300	300	350	400	400	400
G	65	100	100	130	140	140	140	180	180	180	240	240	240	240

MEEM

Probe length and drain, horizontal

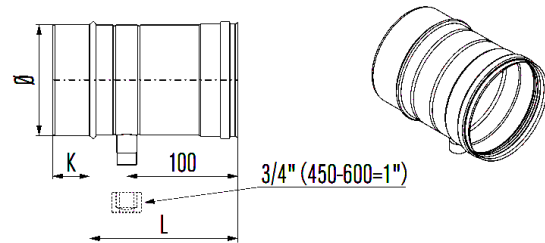

Ø	80	100	113	130	150	180	200	250	300	350	400	450	500	600
K	50	50	50	50	50	50	50	50	50	50	50	55	55	55
L	150	150	150	150	150	150	150	150	150	150	150	155	155	155

MEEMC

Probe length and drain, vertical

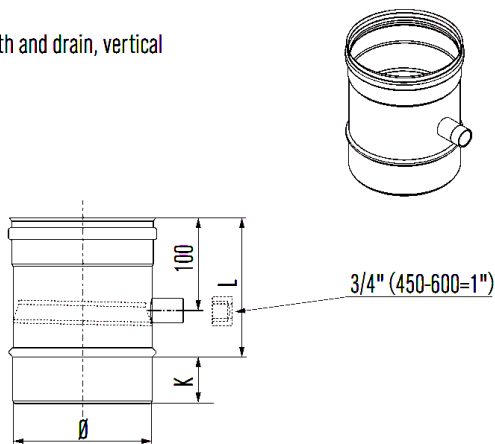

Ø	100	130	150	180	200	450	500	600
K	50	50	50	50	50	55	55	55
L	150	150	150	150	150	155	155	155

MESIC1
Combination silencer 25 dB

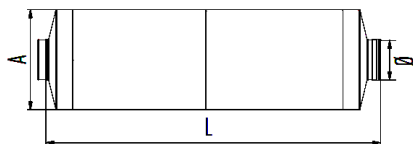
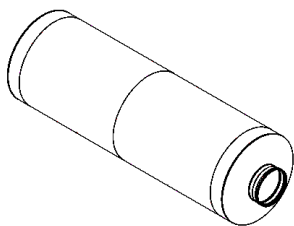

Ø	80	100	130	150	180	200	250	300	350	400	450	500	600
L	1850	1850	1850	1850	2100	2350	2600	3100	3350	3850	4340	4590	4840
A	250	300	400	425	475	525	675	775	875	950	1000	1125	1225

MESIA2
Absorption silencer 35 dB

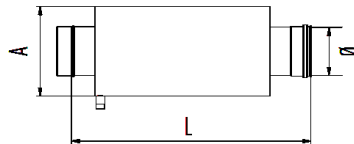
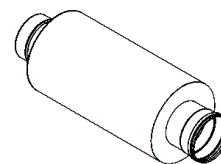

Ø	80	100	130	150	180	200	250	300	350	400	450	500	600
L	980	980	980	980	1230	1480	1480	2480	2480	2480	2970	2970	2970
A	205	225	255	275	325	325	375	425	475	525	575	625	725

MESIR1
Resonance silencer 20 dB

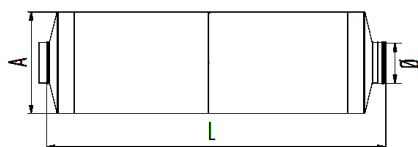
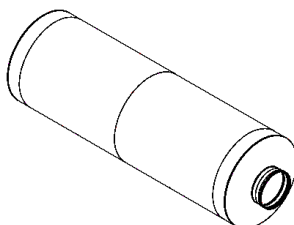

Ø	80	100	130	150	180	200	250	300	350	400	450	500	600
L	2000	2000	2000	2000	2000	2000	2000	2000	2100	2100	2100	2400	2400
A	225	275	325	350	400	450	525	625	725	825	925	1025	1225

MESIR2
Resonance silencer 30 dB

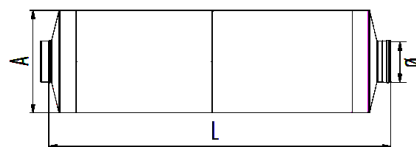
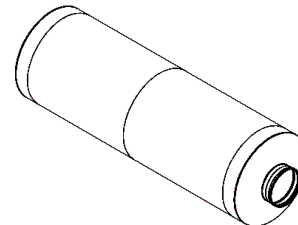

Ø	100	130	150	180	200	250	300	350	400	450	500	600
L	2000	2000	2000	2000	2000	2200	2400	2600	2800	3000	3200	3400
A	450	550	650	700	750	900	900	1000	1100	1200	1250	1450

MESIA1
Absorption silencer 25 dB

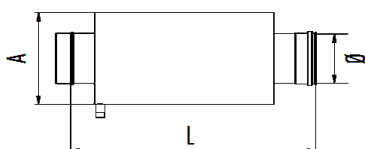
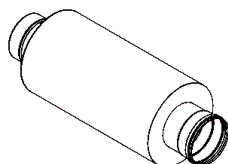

Ø	80	100	130	150	180	200	250	300	350	400	450	500	600
L	580	580	730	730	980	1230	1230	1730	1730	1730	1970	1970	1970
A	205	225	255	275	305	325	375	425	475	525	575	625	725

MESI A

Absorption silencer

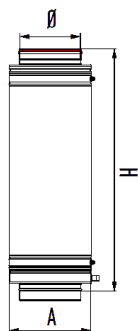
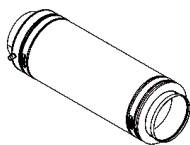

Ø	80	100	130	150	180	200	250	300	350	400	450	500	600
H	600	600	600	600	780	780	780	1140			on request		
A	180	200	230	250	280	300	350	400			on request		

MESI AE

Extension set for MESI A

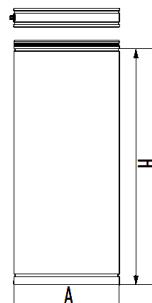
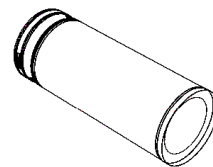

Ø	80	100	130	150	180	200	250	300	350	400	450	500	600
H	390	390	390	390	570	570	570	930			on request		
A	180	200	230	250	280	300	350	400			on request		

MEAPD

Wall support element

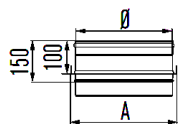
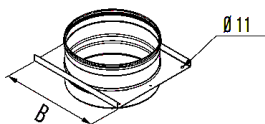

Ø	350	400	450	500	600
A	385	435	485	535	585
B	435	485	535	585	685

MEAPU

Support U-profile (for MEBS/MEBBS)

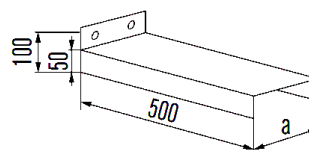

Ø	100	130	150	180	200	250	300	350	400	450	500	600
a	100	130	150	180	200	250	300	350	400	450	500	600

MEAH

Positioner

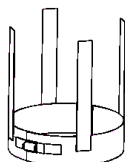
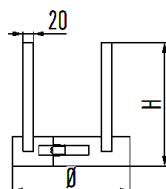

Ø	80	100	113	130	150	180	200	250	300	350	400	450	500	600
H	170	170	170	170	170	170	170	190	190	190	190	190	190	190

MEBP

Support plate (for MEOH)

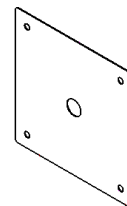
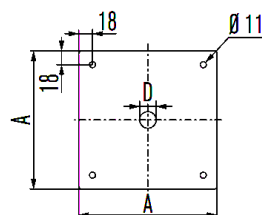

Ø	80	100	113	130	150	180	200	250	300	350	400
A	165	165	165	165	165	220	220	270	320	370	420
D	30	30	30	30	30	35	35	35	35	35	35

MEBS Support for elbow 87°

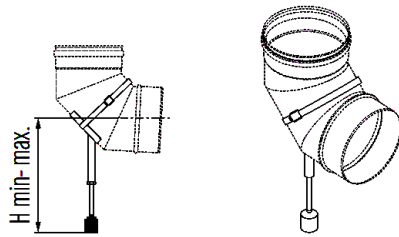

Ø	80	100	113	130	150	180
Hmin	130	130	130	130	130	130
Hmax	200	200	200	200	200	200

MEBBS Support with elbow 87°

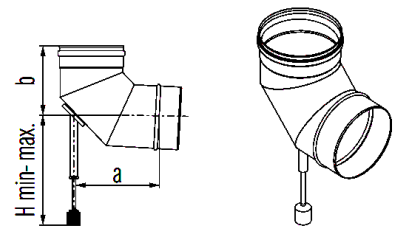

Ø	200	250	300	350	400
Hmin	210	210	210	210	210
Hmax	235	235	235	235	235
a	165	180	275	275	295
b	215	230	230	290	345

MEEB Mounting band

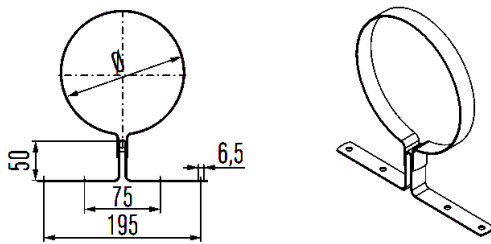

Ø	80	100	113	130	150	180	200	250
---	----	-----	-----	-----	-----	-----	-----	-----

MEKAM Boiler adaptor

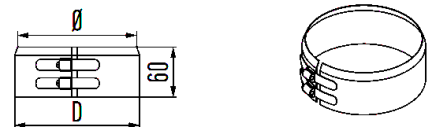

Ø	80	100	113	130	150	180	200	250	300	350	400
D	90	110	123	140	160	190	210	260	310	360	410

MEKBS Locking band with screw fitting

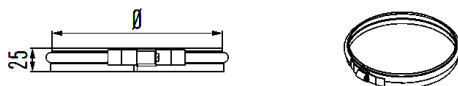

Ø	80	100	113	130	150	180	200	250	300	350	400	450	500	600
---	----	-----	-----	-----	-----	-----	-----	-----	-----	-----	-----	-----	-----	-----

MEKB Locking band

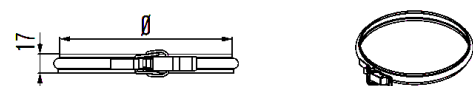

Ø	80	100	113	130	150	180	200	250	300	350	400	450	500	600
---	----	-----	-----	-----	-----	-----	-----	-----	-----	-----	-----	-----	-----	-----

MEMB

Wall band adjustable

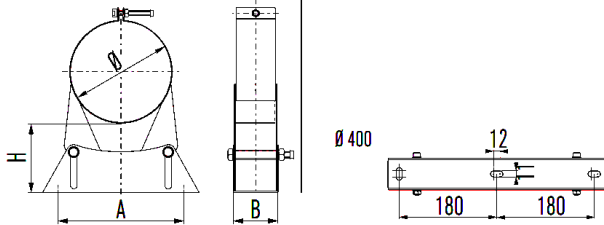

Ø	80	100	113	130	150	180	200	250	300	350	400	450	500	600
A	116	116	116	160	160	160	160	160	160	360	360	360	360	410
B	35	35	35	55	55	55	55	55	55	55	60	60	60	60
H	25-50	25-50	25-50	50-90	50-90	50-90	50-90	50-90	50-90	50-90	50-90	50-90	50-90	50-90

MEMBV2/3/4

Wall band adjustable

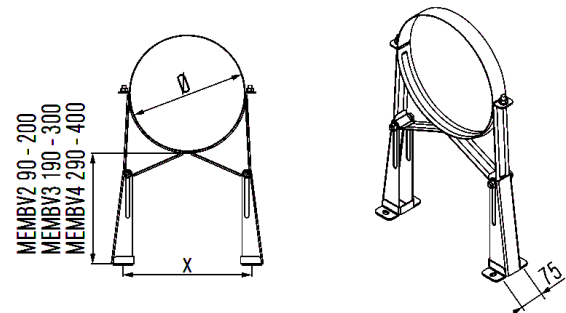

Ø	150	180	200	250	300	350	400	450	500	600
x	180	210	230	280	330	380	430	480	510	610

MESK

Reinforced locking band

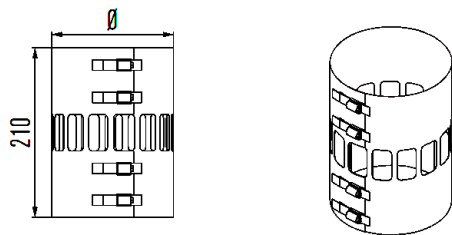

Ø	80	100	113	130	150	180	200	250	300	350	400
---	----	-----	-----	-----	-----	-----	-----	-----	-----	-----	-----

MESZ

Shaft support

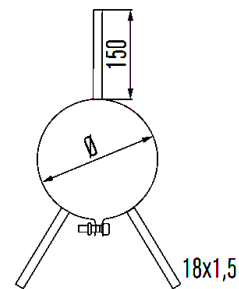

Ø	80	100	113	130	150	180	200
---	----	-----	-----	-----	-----	-----	-----

MEMO

Band for wall support

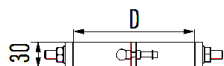
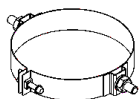

Ø	80	100	113	130	150	180	200	250	300	350	400	450	500	600
D	80	100	113	130	150	180	200	250	300	350	400	450	500	600

MEZS

Shaft support with twin wall connector, incl. brackets (for negative pressure only)

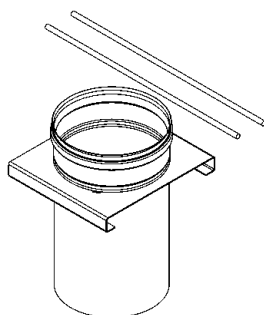
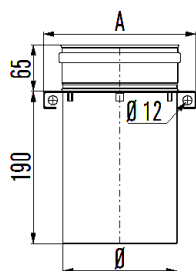

Ø	113	130	150	180	200	250
A	155	170	190	220	240	290

MES

Storm collar

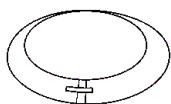
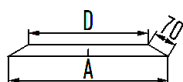

Ø	80	100	113	130	150	180	200	250	300	350	400	450	500	600
A	205	225	255	255	275	305	325	375	425	475	525	575	625	725

MEOH 2 / MEOH 4

Support heavy (pair) for MEBP/MEAPO

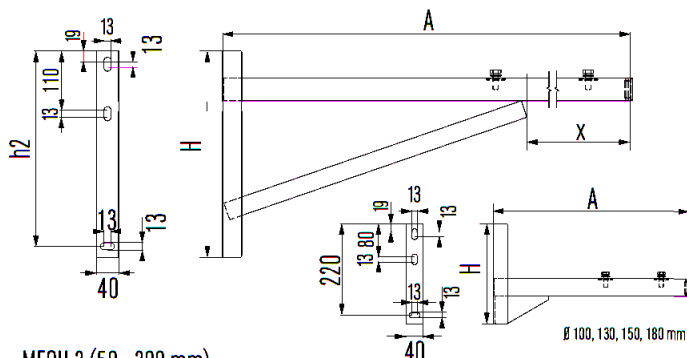
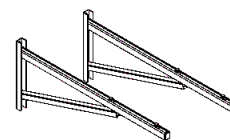

MEOH 2 (50 - 200 mm)

Ø	80	100	130	150	180	200	250	300	350	400	450	500	600
A	475	475	475	475	475	600	600	600	740	740	740	915	915
H	240	240	240	240	240	330	330	330	330	330	330	380	380
h2	-	-	-	-	-	-	310	310	310	310	310	360	360
x	-	-	-	-	-	-	270	270	330	330	330	355	355

MEOH 4 (200 - 400 mm)

Ø	80	100	130	150	180	200	250	300	350	400	450	500	600
A	600	600	600	600	740	740	740	740	915	915	915	1090	1090
H	330	330	330	330	330	330	330	330	380	380	380	430	430
h2	310	310	310	310	310	310	310	310	360	360	360	410	410
x	270	270	270	270	330	330	330	330	355	355	355	350	350

x = Max. distance to cut

MEOL 1 / MEOL 2

Support light (pair) for MEMO

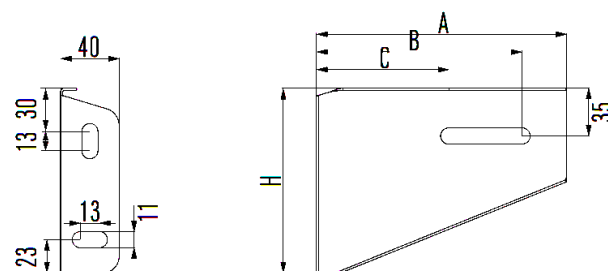
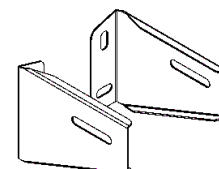

MEOL 1 (50 - 90 mm)

Ø	80	100	113	130	150	180	200	250	300
A	170	170	185	185	220	220	220	285	285
B	140	140	155	155	190	190	190	255	255
C	90	90	105	105	125	125	125	130	130
H	125	125	140	140	170	170	170	230	230

MEOL 2 (90 - 200 mm)

Ø	80	100	113	130	150	180	200	250	300
A	285	285	295	295	315	335	335	370	395
B	255	255	265	265	285	305	305	340	365
C	130	130	145	145	165	180	180	215	240
H	230	230	235	235	255	275	275	305	325

SYSTEM ME

MESAD

Shaft cover plate with ventilation

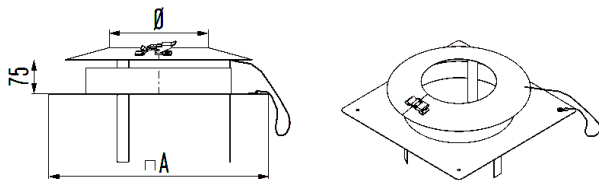

Ø	80	100	113	130	150	180	200	250	300	350	400	450	500	600
A	335	335	335	335	335	425	425	425	665	665	665	715	765	865

MEDH

Slope roof flashing 5° - 30°

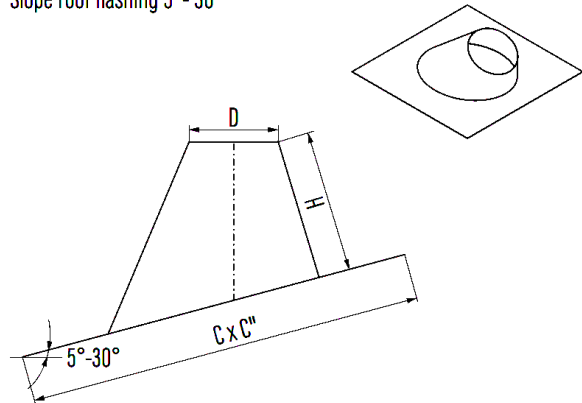

Ø	80	100	130	150	180	200	250	300	350	400	450	500	600
D	85	105	135	155	185	205	255	305	355	405	455	505	605
C	430	465	500	520	550	575	630	685	740	795	850	890	990
C''	420	455	490	500	530	550	600	655	705	760	810	860	960
H	130	140	150	155	160	160	170	175	185	195	200	210	220

MEDP

Flat roof flashing

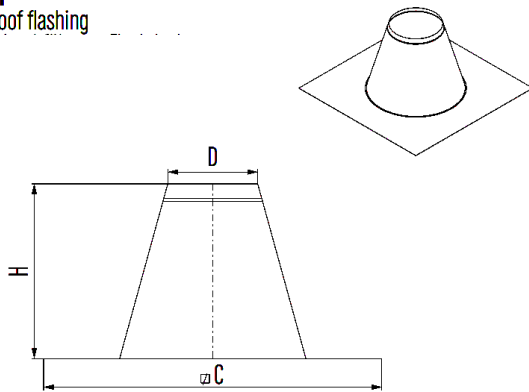

Ø	80	100	130	150	180	200	250	300	350	400	450	500	600
D	90	110	140	160	190	210	240	310	360	410	460	510	610
C	370	390	420	440	470	490	520	590	640	690	740	790	890
H	200	200	200	315	315	315	315	315	315	315	315	315	315

MEK

All weather cap

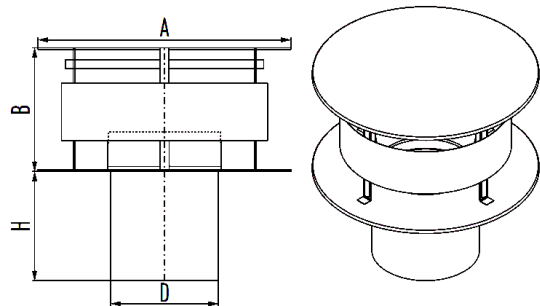

Ø	80	100	130	150	180	200	250	300	350	400	450	500	600
A	175	220	285	330	395	440	550	660	770	880	890	990	1190
B	90	110	145	165	200	220	275	330	385	440	860	910	960
D	78	98	127	147	177	197	247	297	347	397	447	497	597
H	120	150	195	210	270	300	375	450	525	600	625	750	900

MEKI

Inspection element with condensate drain

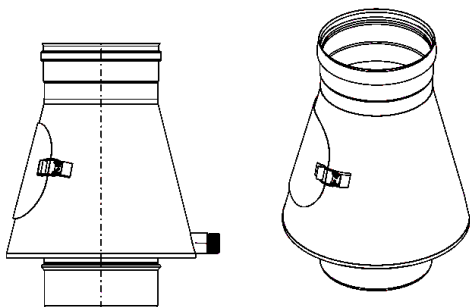

Ø	80	100	113	130	150	180	200	250	300	350	400
H	200	200	200	250	250	250	250	300	300	300	350
G	65	100	100	130	140	140	140	180	180	180	240

MEKR

All weather cap with inspection

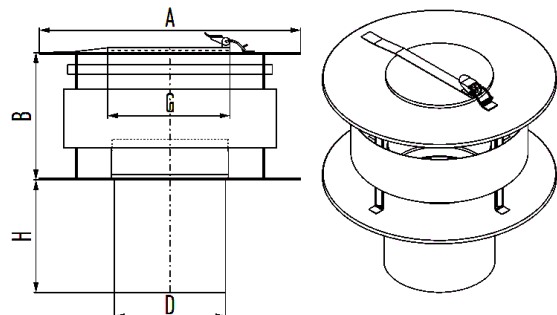

Ø	80	100	113	130	150	180	200	250	300	350	400	450	500	600
A	175	220	285	285	330	395	440	550	660	770	880	890	990	1190
B	90	110	145	145	165	200	220	275	330	385	440	860	910	1190
D	78	98	110	127	147	177	197	247	297	347	397	447	497	597
H	120	150	165	195	210	270	300	375	450	525	600	625	750	900
G	80	100	115	130	150	180	200	250	250	250	250	250	250	250

SYSTEM ME

MEMS

Cap

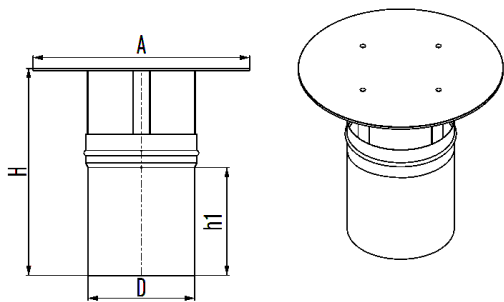

Ø	130	150	180	200
A	285	330	395	440
D	127	147	177	197
H	330	370	440	475
h1	195	225	270	300

MEAS

Mounting aid

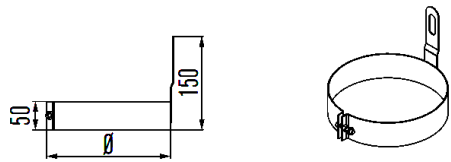

Ø	80	100	113	130	150	180	200	250
---	----	-----	-----	-----	-----	-----	-----	-----

MEKSP

Condensate cover (for use with MERE)

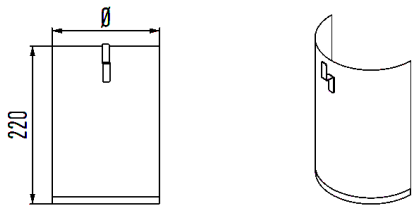

Ø	130	150
---	-----	-----

METE

End cap for tee-piece

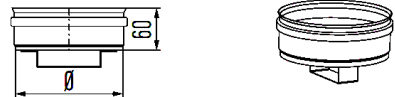

Ø	80	100	113	130	150	180	200	250	300	350	400	450	500	600
---	----	-----	-----	-----	-----	-----	-----	-----	-----	-----	-----	-----	-----	-----

MEE 0304

Cap

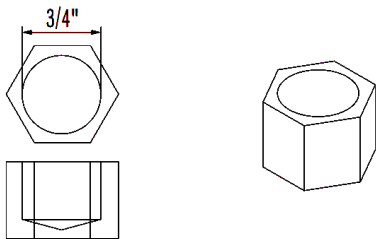

MENLT

Draught stabiliser, adjustment range from 10 till 60 Pa



Ø	130	150	180
---	-----	-----	-----

SYSTEM ME

MELG
Air inlet

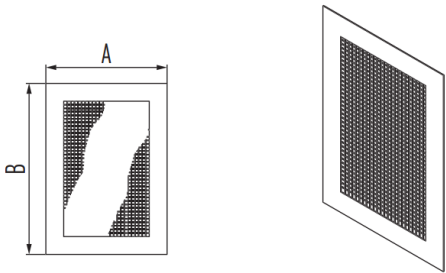

Ø	113	130	150	200
A	170	170	215	215
B	240	240	310	310

MEVRE 99
Extension casing (for use with MERE)

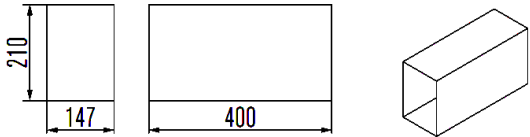

MERT 99
Inspection cover with frame

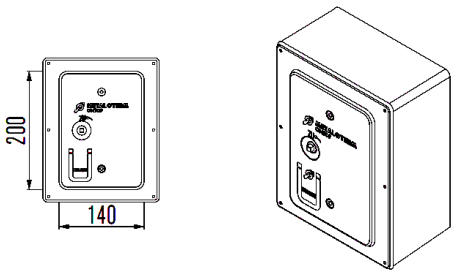

MEW
Spark arrester mesh

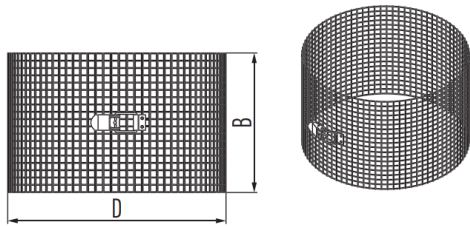

Ø	130	150	180
D	210	240	290
B	135	160	190

MERTG 99
Inspection cover with frame

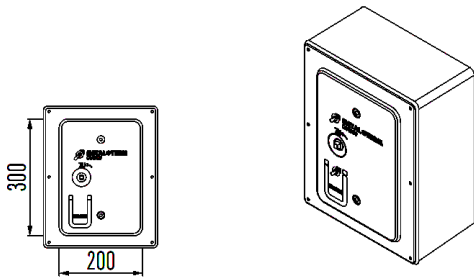

ME-EPDM
Seal EPDM
Temperatures always below 120 degrees



Ø	80	100
---	----	-----

MEDRV
Seal Viton
for oil-containing exhaust gases



Ø	80	100	130	150	180	200	250
---	----	-----	-----	-----	-----	-----	-----

Whilst every effort has been made to provide reliable information and dimension accuracy, Sigram Flue Systems Ltd, do not hold themselves responsible for possible errors of an editorial nature, however caused.

Sigram are committed to the concept of continuous quality and improvement and therefore reserves the right to alter product specification without notice.



**UNIT E2
MEADOWBANK BUSINESS PARK
TWEEDALE WAY
CHADDERTON
OLDHAM, OL9 8EH**

**TEL: 0161 682 1999
FAX: 0161 681 9855
EMAIL: sales@sigram.co.uk
WEB: www.sigram.co.uk**