



TEL: 0161 682 1999  
FAX: 0161 681 9855  
E-MAIL: [sales@sigram.co.uk](mailto:sales@sigram.co.uk)  
WEB: [www.sigram.co.uk](http://www.sigram.co.uk)

## FLUE SYSTEM UK



## SYSTEM UK TWIN WALL



# SYSTEM UK

## Technical Data SYSTEM UK

<b>Application</b>	<b>Balanced flue/direct vent</b>	
<b>Operating Mode</b>	<b>Dry/Wet</b>	
<b>Pressure</b>	<b>Negative/positive pressure</b>	
<b>Max. Working pressure</b>	<b>200 Pa</b>	
<b>Operating temperature</b>	<b>200 °C</b>	
<b>Max. temperature allowed</b>	<b>200 °C</b>	
<b>Inner wall material</b>	<b>AISI 316L/EN 1.4404</b>	
<b>thickness</b>	<b>minimal 0.4mm</b>	
<b>Outer wall material</b>	<b>AISI 304/3N 1.4301</b>	
<b>thickness</b>	<b>minimal 0.5mm</b>	
<b>Sealant</b>	<b>Elastomer</b>	
<b>Fuel type</b>	<b>Oil/natural gas/calor gas/propane gas</b>	

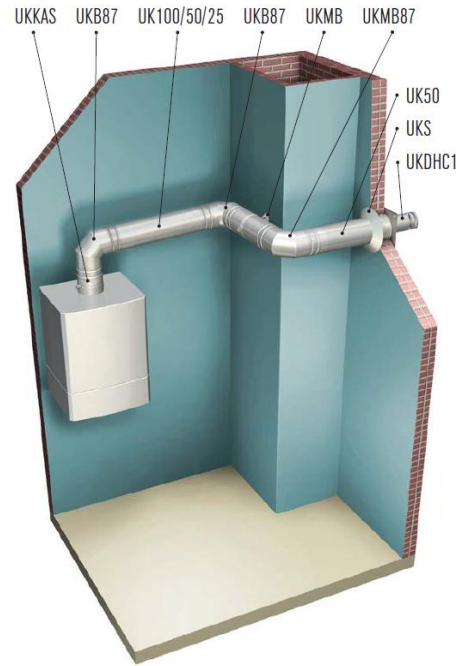

### INSTALLATION NOTES SPECIFICALLY FOR CONDENSING APPLICATIONS.

On all condensing applications, system must be fitted with a minimum 3 degree slope back towards the appliance/s. (appliance and/or system drain point required at lowest point/s.)

Note: A system slope of 3 degrees equates to 5.2CM per linear metre.

Systems must be adequately supported, with horizontal run supports not exceeding two metre centres.

## Applications SYSTEM UK

- Concentric flue-system for balanced flue/direct vent gas-fired boilers
- Combined flue-system and air inlet for heating room

## Advantages SYSTEM UK

- Boiler adaptors are being manufactured on specification
- Durable system due to extra beads
- Easy assemble; lightweight elements
- Wide product range offers solutions for virtually all situations
- Fully welded system
- Sealing rings pre-mounted in every product
- Horizontal and vertical terminals

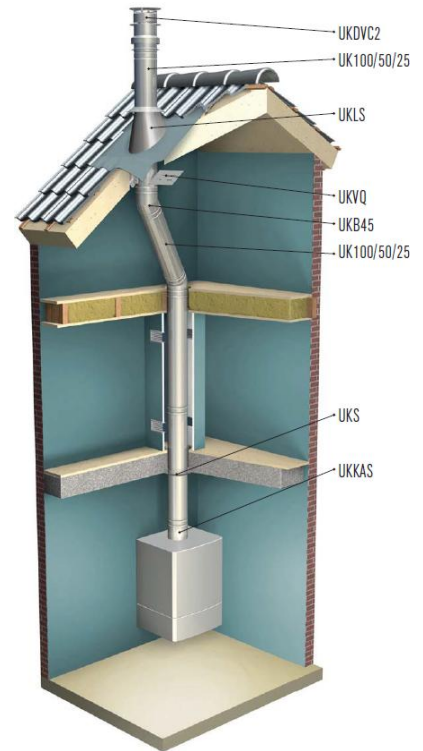

	DIAMETER		CROSS SECTIONAL AREA					WEIGHT KG/M	
Inner Diameter mm	80	100							
Outer Diameter mm	125	150							
Cross Section cm <sup>2</sup>	70	98							
Weight kg/m	2.1	2.6							

**UKKAS**  
Adaptor

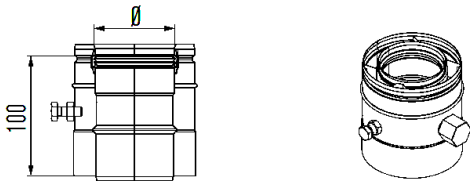

Ø 80 100

**UKVG**  
Increaser

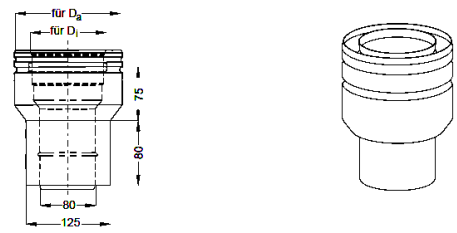

Di 80 100  
Da 125 150

**UKB 43 08**  
Elbow 43°

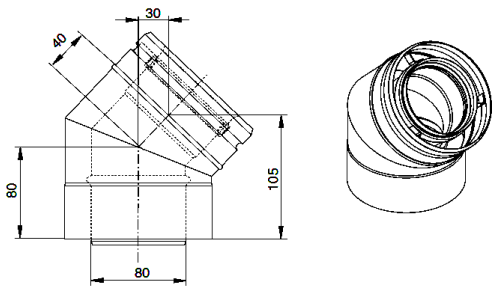

**UKB 43 10**  
Elbow 43°

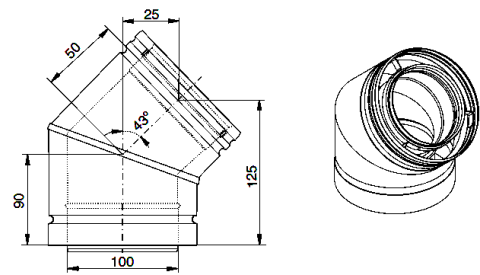

**UKB 87 08**  
Elbow 87°

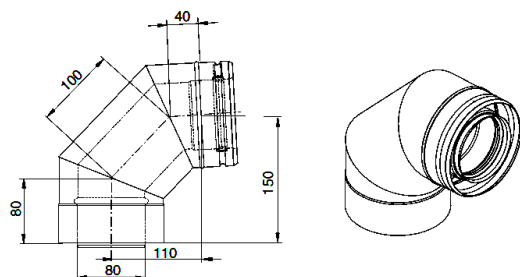

**UKB 87 10**  
Elbow 87°

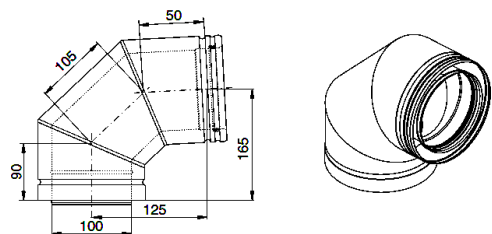

**UKBI 87**  
Elbow 87° with inspection cover

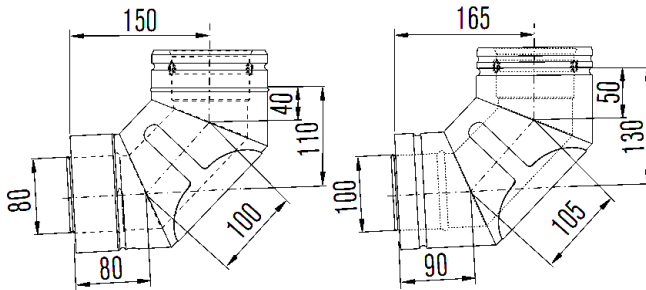
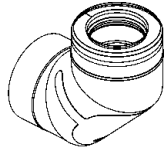

**UKBLG 08**  
Elbow 87° with air inlet

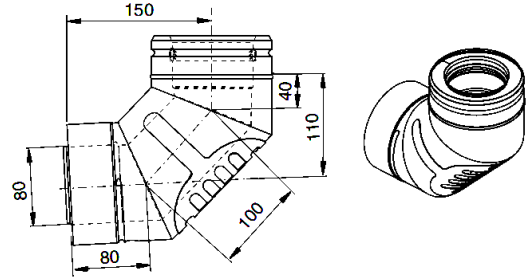

**UKBLG 10**  
Elbow 87° with air inlet

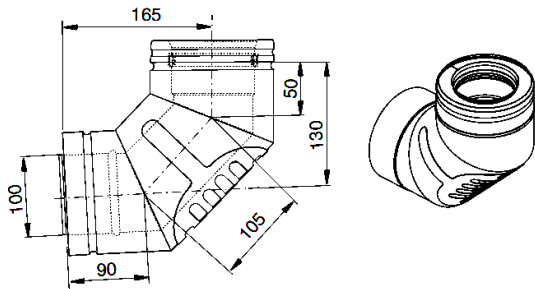

**UKT 87 08**  
Tee-piece 87°

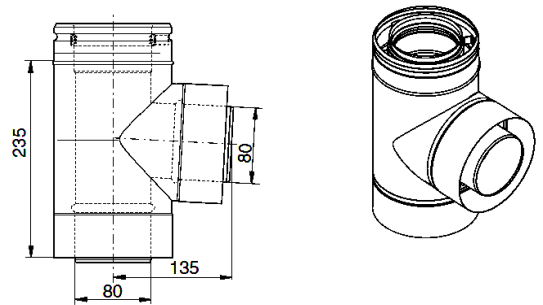

**UKT 87 10**  
Tee-piece 87°

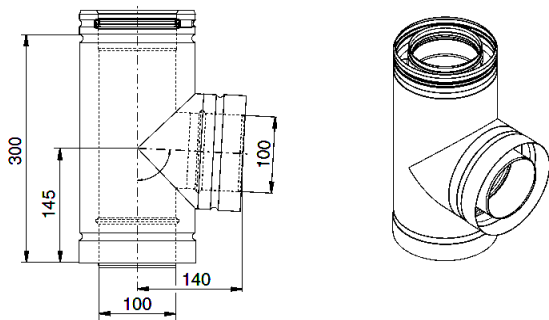

**UK 100/50/25/10**  
Length

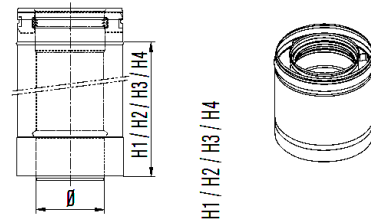

Ø	80
H1	950
H2	450
H3	200
H4	100

**UKEM**  
Probe length

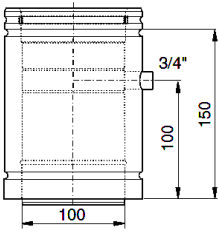

Ø 80 100

**UKI 08**  
Inspection length

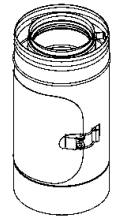
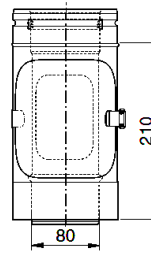

**UKI 10**  
Inspection length

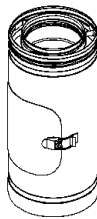
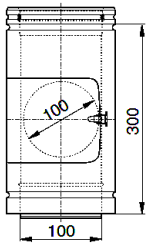

**UKILG**  
Inspection length with air supply

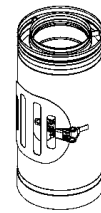
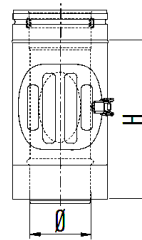

Ø 80 100  
H 205 300

**UKPP 08**  
Adjustable length

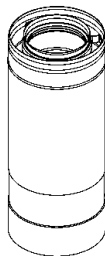
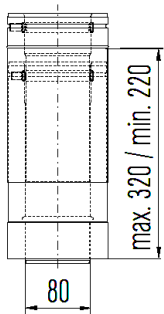

**UKPP 10**  
Adjustable length

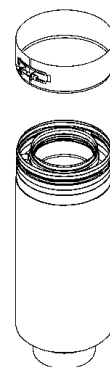
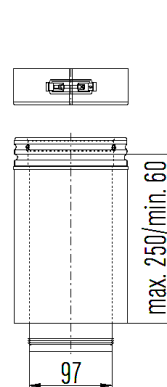

**UKKB 08**  
Locking band

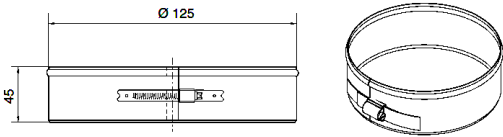

**UKKB 10**  
Locking band

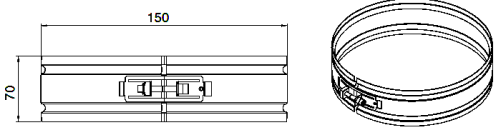

**UKBT**  
Guy-wire band

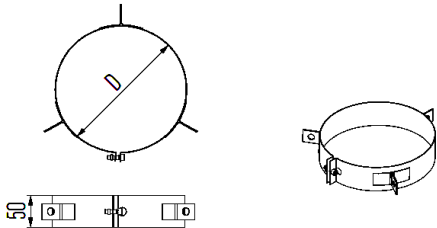

Ø 80 100  
D 125 150

**UKDQ**  
Roof support

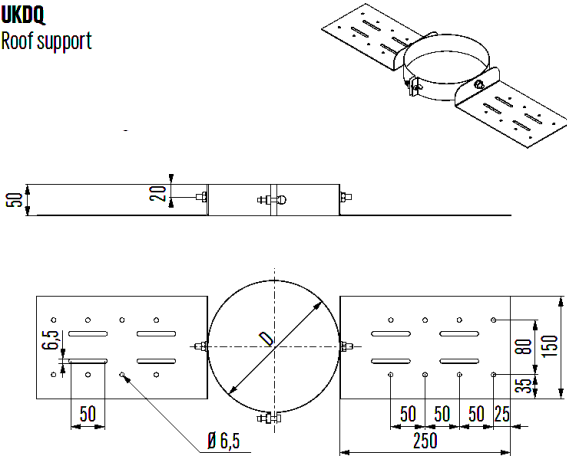

Ø 80 100  
D 125 150

**UKMB 08**  
Wall band adjustable

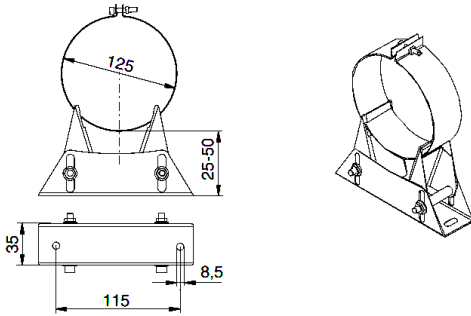

**UKMB 10**  
Wall band adjustable

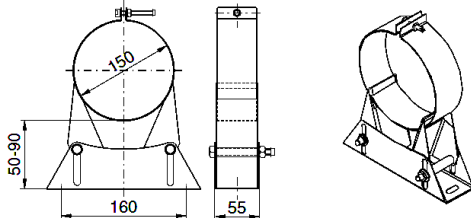

**UKSK 08**  
Reinforced locking band

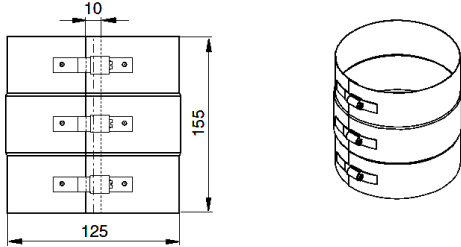

**UKSK 10**  
Reinforced locking band

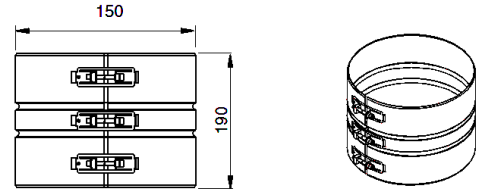

**UKMO**  
Band for wall support

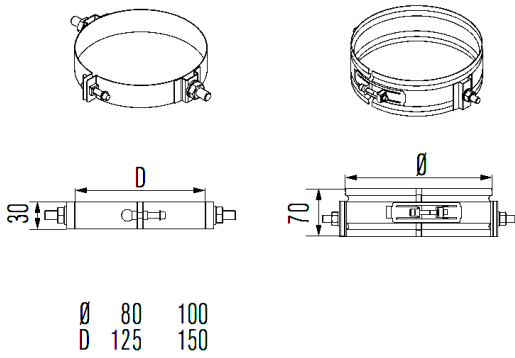

**UKVQ**  
Ceiling support

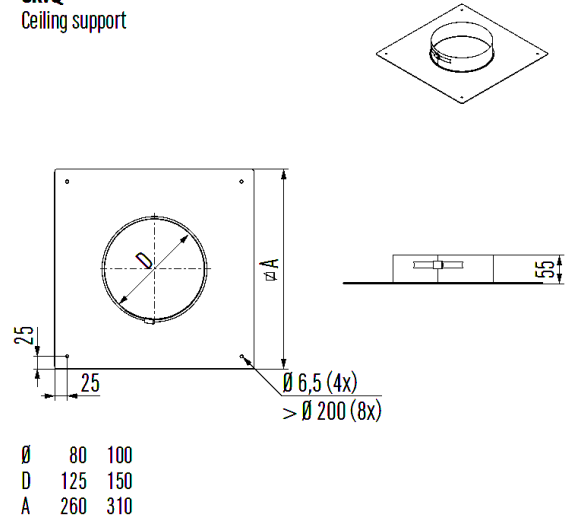

**UKS**  
Storm collar

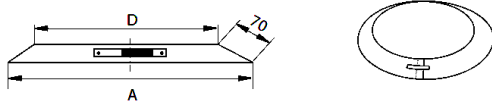

Ø	80	100
A	250	275
D	125	150

**UKDHC1**  
Horizontal terminal excentric with small wall cover

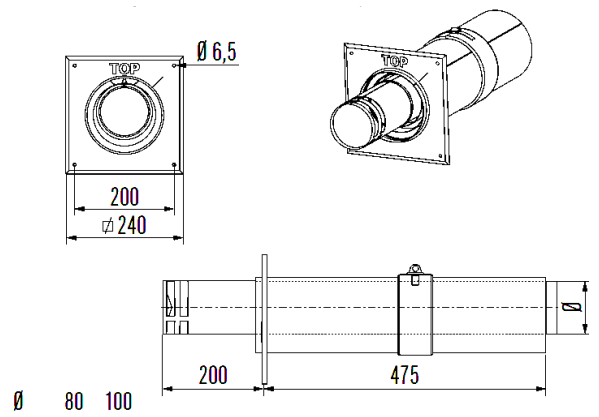

**UKDVC2 08**  
Vertical terminal

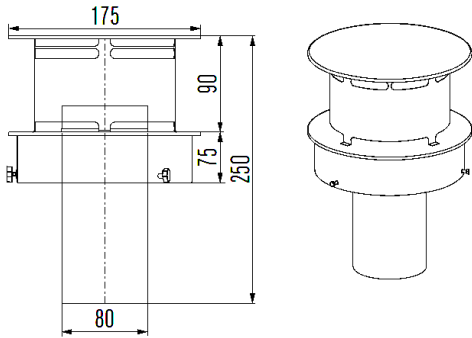

**UKDVC2 10**  
Vertical terminal + UKKB

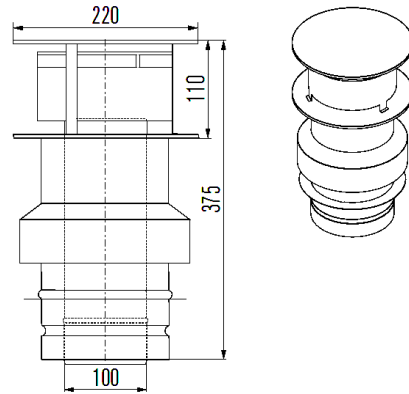

**UKMA 10**  
Top stub

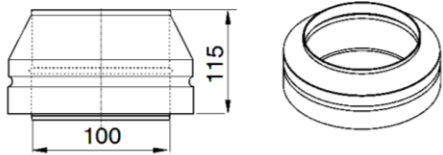

**UKTE 08**  
End cap for tee-piece

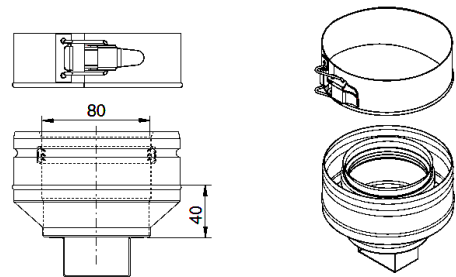

**UKTE 10**  
End cap for tee-piece

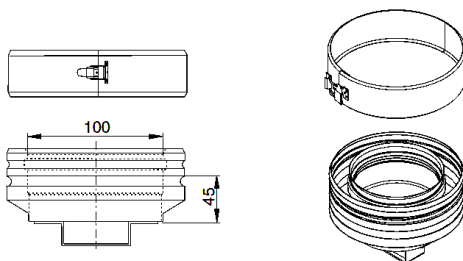

**UKCP**  
Cover plates (pair)

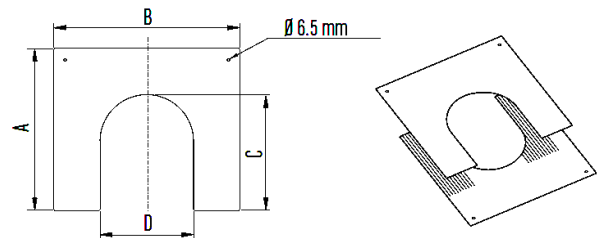

Ø	80	100
A	325	350
B	250	275
C	150	175
D	125	150



**Whilst every effort has been made to provide reliable information and dimension accuracy, Sigram Flue Systems Ltd, do not hold themselves responsible for possible errors of an editorial nature, however caused.**

**Sigram are committed to the concept of continuous quality and improvement and therefore reserves the right to alter product specification without notice.**



**UNIT E2  
MEADOWBANK BUSINESS PARK  
TWEEDALE WAY  
CHADDERTON  
OLDHAM, OL9 8EH**

**TEL: 0161 682 1999  
FAX: 0161 681 9855  
EMAIL: [sales@sigram.co.uk](mailto:sales@sigram.co.uk)  
WEB: [www.sigram.co.uk](http://www.sigram.co.uk)**